

NOTICE!!

These documents have been scanned!

Do not place un-scanned documents beneath this notice!

Do not remove this notice from this file!

GPO Jacket No. 560-102
Print Order 61540
Rise Business Services, LLC
Job=AZ15 5/8/2019



Box Number= AZ15023



Claim Begin-End: AMC433903-AMC433906

1 Initial Receipt



AZ15023-10

AMC433804-AMC434503

United States Department of the Interior
Bureau of Land Management
LANDS/RECREATION & PLANNING
ONE N CENTRAL AVE
PHOENIX, AZ 85004 -2203
Phone: 602-417-9200

Receipt

No: 3412577

Transaction #: 3511348	
Date of Transaction: 10/14/2015	
CUSTOMER:	
DEPARTMENT OF LAND TRANSFER INFORMATION INC 942 CALLE AMANECER STE B SAN CLEMENTE, CA 92673-6220 US	

LINE #	QTY	DESCRIPTION	REMARKS	UNIT PRICE	TOTAL
1	4.00	LOCATABLE MINERALS / MINING CLAIMS-NEW, UNADJUD, ONE OR MORE AUTH NOS / NEW MINING CLAIMS LOCATION FEE CASES: AMC433903/\$37.00, AMC433904/\$37.00, AMC433905/\$37.00, AMC433906/\$37.00		- n/a -	148.00
2	4.00	LOCATABLE MINERALS / MINING CLAIMS-NEW, UNADJUD, ONE OR MORE AUTH NOS / NEW MINING CLAIM PROCESSING FEE CASES: AMC433903/\$20.00, AMC433904/\$20.00, AMC433905/\$20.00, AMC433906/\$20.00		- n/a -	80.00
3	4.00	LOCATABLE MINERALS / MINING CLAIMS-NEW, UNADJUD, ONE OR MORE AUTH NOS / NEW MINING CLAIMS MAINTENANCE FEE CASES: AMC433903/\$155.00, AMC433904/\$155.00, AMC433905/\$155.00, AMC433906/\$155.00		- n/a -	620.00
TOTAL:					\$848.00

PAYMENT INFORMATION				
1	AMOUNT:	848.00	POSTMARKED:	10/09/2015
	TYPE:	CHECK	RECEIVED:	10/13/2015
	CHECK NO:	6307		
	NAME:	DEPARTMENT OF LAND TRANSFER INFORMATION INC 942 CALLE AMANECER BLDG B/MS54 SAN CLEMENTE CA 92673-6220 US		

REMARKS

This receipt was generated by the automated BLM Collections and Billing System and is a paper representation of a portion of the official electronic record contained therein.

NOTICE!!

These documents have been scanned!

Do not place un-scanned documents beneath this notice!

Do not remove this notice from this file!

GPO Jacket No. 560-102
Print Order 61540
Rise Business Services, LLC
Job=AZ15 5/8/2019



Box Number= AZ15023



Claim Begin-End: AMC433903-AMC433906

2 Correspondence



AZ15023-10

AMC433804-AMC434503



United States Department of the Interior

BUREAU OF LAND MANAGEMENT

Arizona State Office

One North Central Avenue, Suite 800

Phoenix, Arizona 85004-4427

www.blm.gov/az/



DEC 20 2017

In Reply Refer To:

3830 (9200) PB

AMC414381, AMC429642, AMC433903

CERTIFIED MAIL - RETURN RECEIPT REQUESTED No. 7017 0190 0000 4056 5959

DECISION

DONALD & JASON KARPOWICH : This decision affects those claims shown
PO BOX 3780 SITE 315 : in the block below.
MESQUITE, NV 89024-3780 :

AMC414389, AMC429642, AMC433905

GOLDEN CROWN #12, DIAMOND JOE MINE, SAMOA EAST

MINING CLAIMS DECLARED FORFEITED

The mining claims listed above have been declared forfeited as of September 1, 2017, for failure to timely file the required maintenance fee payment or small miner's maintenance fee waiver (waiver).

Claimants are required to pay an annual non-refundable maintenance fee of \$155 per 20 acres or portion thereof, or submit a waiver, on or before September 1 of each year. These requirements were established by 30 U.S.C. 28f-1, as amended, and 43 CFR 3834 and 3835.

Our records do not show receipt of a maintenance fee payment or small miner waiver filed on or before the due date. Therefore, the claims listed above are forfeited.

Reclamation Requirements

This decision does not relieve you of the liability for reclamation of all areas disturbed by your activities on lands covered by the subject mining claim(s) and/or site(s). After you complete the reclamation, you must notify the authorized officer of the appropriate surface managing agency so that the authorized officer may conduct a final site inspection and determine whether you may be released from liability. If you fail to reclaim the land to the satisfaction of the authorized officer,

the surface management agency may cite you for noncompliance under its surface management regulations. For land administered by the Bureau of Land Management (BLM), if you fail to reclaim the land to the satisfaction of the authorized officer as required in 43 CFR Subpart 3809, BLM will issue an order of noncompliance under 43 CFR 3809.601(a). If you fail to comply with the non-compliance order, BLM may take further action under 43 CFR 3809.604. Failure to conduct reclamation is a prohibited act that may subject you to criminal penalties. See 43 CFR 3809.605(h) and 43 CFR 3809.700.

Appeal Procedures

This decision may be appealed to the Interior Board of Land Appeals, Office of the Secretary, in accordance with the regulations contained in 43 CFR, Part 4, and the enclosed Form 1842-1. If an appeal is taken, your notice of appeal must be filed in this office (at the above address) within 30 days from receipt of this decision. The appellant has the burden of showing that the decision appealed from is in error.

If you wish to file a petition pursuant to regulation 43 CFR 4.21 (58 FR 4939, January 19, 1993) for a stay of the effectiveness of this decision during the time that your appeal is being reviewed by the Board, the petition for a stay must accompany your notice of appeal. A petition for a stay is required to show sufficient justification based on the standards listed below. Copies of the notice of appeal and petition for a stay **must** also be submitted to each party named in this decision and to the Interior Board of Land Appeals and to the appropriate Office of the Solicitor (see 43 CFR 4.413) at the same time the original documents are filed with this office. If you request a stay, you have the burden of proof to demonstrate that a stay should be granted.

Standards for Obtaining a Stay

Except as otherwise provided by law or other pertinent regulation, a petition for a stay of a decision pending appeal shall show sufficient justification based on the following standards:

- (1) The relative harm to the parties if the stay is granted or denied,
- (2) The likelihood of the appellant's success on the merits,
- (3) The likelihood of immediate and irreparable harm if the stay is not granted, and
- (4) Whether the public interest favors granting the stay.

Please include your AMC serial number(s) on all correspondence. If additional information is required, please call Pauline Brown at 602-417-9360.

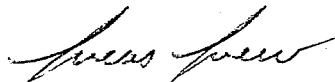

Lucas Lucero
Deputy State Director
Lands, Minerals, and Energy Division

Enclosure

Track Another Package +

Tracking Number: 70170190000040565959

Remove X

Your item has been delivered and is available at a PO Box at 9:11 am on December 23, 2017 in MESQUITE, NV 89024.

Delivered

December 23, 2017 at 9:11 am
Delivered, PO Box
MESQUITE, NV 89024

Tracking History

December 23, 2017, 9:11 am

Delivered, PO Box
MESQUITE, NV 89024

Your item has been delivered and is available at a PO Box at 9:11 am on December 23, 2017 in MESQUITE, NV 89024.

December 23, 2017, 8:50 am

Available for Pickup
MESQUITE, NV 89024

December 23, 2017, 8:33 am

Distribution to PO Box in Progress
MESQUITE, NV 89027

December 23, 2017, 8:23 am

Sorting Complete
MESQUITE, NV 89027

December 23, 2017, 7:46 am

Arrived at Unit
MESQUITE, NV 89027

December 23, 2017, 2:10 am

Departed USPS Regional Facility
LAS VEGAS NV DISTRIBUTION CENTER

December 22, 2017, 2:50 pm
Arrived at USPS Regional Facility
LAS VEGAS NV DISTRIBUTION CENTER

December 22, 2017, 10:44 am
Departed USPS Regional Facility
PHOENIX AZ DISTRIBUTION CENTER

December 21, 2017, 8:49 pm
Arrived at USPS Regional Facility
PHOENIX AZ DISTRIBUTION CENTER

Product Information



See Less ^

Can't find what you're looking for?

Go to our FAQs section to find answers to your tracking questions.

FAQs (<http://faq.usps.com/?articleId=220900>)

The easiest tracking number is the one you don't have to know.

With Informed Delivery®, you never have to type in another tracking number. Sign up to:

SENDER: COMPLETE THIS SECTION**COMPLETE THIS SECTION ON DELIVERY**

- Complete items 1, 2, and 3.
- Print your name and address on the reverse so that we can return the card to you.
- Attach this card to the back of the mailpiece, or on the front if space permits.

A. Signature

X 

-
- Agent
-
-
- Addressee

B. Received by (Printed Name)

C. Date of Delivery

12/14/17

1. Article Addressed to:

ROBERT G DENBERRY
 12207 NELS PETERS RD
 EVERETT WA 98208-5806
 9200 RM AMC433903

D. Is delivery address different from item 1? Yes
 If YES, enter delivery address below: No



9590 9402 2629 6336 6620 12

2. Article Number (Transfer from service label)

7017 0660 0000 3024 2857

3. Service Type

- Adult Signature
- Adult Signature Restricted Delivery
- Certified Mail®
- Certified Mail Restricted Delivery
- Collect on Delivery
- Collect on Delivery Restricted Delivery

- Priority Mail Express®
- Registered Mail™
- Registered Mail Restricted Delivery
- Return Receipt for Merchandise
- Signature Confirmation™
- Signature Confirmation Restricted Delivery

1 Mail
 1 Mail Restricted Delivery
 500)

USPS TRACKING #

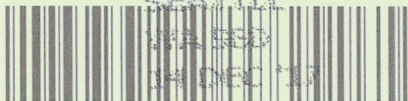

SEATTLE
9402
2629
336 1620 12

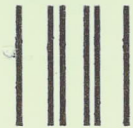

First-Class Mail
Postage & Fees Paid
USPS
Permit No. G-10

9590 9402 2629 336 1620 12

United States
Postal Service

RECEIVED
BLM AZ STATE OFFICE

2017 DEC 18 P 2:01

PHOENIX, ARIZONA

Sender: Please print your name, address, and ZIP+4® in this box®
U.S. DEPARTMENT OF THE INTERIOR
BUREAU OF LAND MANAGEMENT
PHOENIX, ARIZONA STATE OFFICE
ONE NORTH CENTRAL AVENUE, SUITE 800
PHOENIX, AZ 85004-4427

4-442700

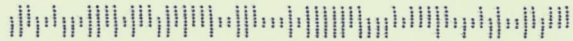



United States Department of the Interior



BUREAU OF LAND MANAGEMENT

Arizona State Office

One North Central Avenue, Suite 800

Phoenix, Arizona 85004-4427

www.blm.gov/az/

DEC 07 2017

In Reply Refer To:

3830 (9200) RM

AMC433903

CERTIFIED MAIL - RETURN RECEIPT REQUESTED No. 7017 0660 0000 3024 2857

DECISION

ROBERT G DENBERRY
12207 NELS PETERS RD
EVERETT, WA 98208-5806

: This decision affects those claims shown
: in the block below.
:

AMC433906
TRINITY

MINING CLAIMS DECLARED FORFEITED

The mining claims listed above have been declared forfeited as of September 1, 2017, for failure to timely file the required maintenance fee payment or small miner's maintenance fee waiver (waiver).

Claimants are required to pay an annual non-refundable maintenance fee of \$155 per 20 acres or portion thereof, or submit a waiver, on or before September 1 of each year. These requirements were established by 30 U.S.C. 28f-1, as amended, and 43 CFR 3834 and 3835.

Our records do not show receipt of a maintenance fee payment or small miner waiver filed on or before the due date. Therefore, the claims listed above are forfeited.

Reclamation Requirements

This decision does not relieve you of the liability for reclamation of all areas disturbed by your activities on lands covered by the subject mining claim(s) and/or site(s). After you complete the reclamation, you must notify the authorized officer of the appropriate surface managing agency so that the authorized officer may conduct a final site inspection and determine whether you may be released from liability. If you fail to reclaim the land to the satisfaction of the authorized officer,

-2 -

the surface management agency may cite you for noncompliance under its surface management regulations. For land administered by the Bureau of Land Management (BLM), if you fail to reclaim the land to the satisfaction of the authorized officer as required in 43 CFR Subpart 3809, BLM will issue an order of noncompliance under 43 CFR 3809.601(a). If you fail to comply with the non-compliance order, BLM may take further action under 43 CFR 3809.604. Failure to conduct reclamation is a prohibited act that may subject you to criminal penalties. See 43 CFR 3809.605(h) and 43 CFR 3809.700.

Appeal Procedures

This decision may be appealed to the Interior Board of Land Appeals, Office of the Secretary, in accordance with the regulations contained in 43 CFR, Part 4, and the enclosed Form 1842-1. If an appeal is taken, your notice of appeal must be filed in this office (at the above address) within 30 days from receipt of this decision. The appellant has the burden of showing that the decision appealed from is in error.

If you wish to file a petition pursuant to regulation 43 CFR 4.21 (58 FR 4939, January 19, 1993) for a stay of the effectiveness of this decision during the time that your appeal is being reviewed by the Board, the petition for a stay must accompany your notice of appeal. A petition for a stay is required to show sufficient justification based on the standards listed below. Copies of the notice of appeal and petition for a stay **must** also be submitted to each party named in this decision and to the Interior Board of Land Appeals and to the appropriate Office of the Solicitor (see 43 CFR 4.413) at the same time the original documents are filed with this office. If you request a stay, you have the burden of proof to demonstrate that a stay should be granted.

Standards for Obtaining a Stay

Except as otherwise provided by law or other pertinent regulation, a petition for a stay of a decision pending appeal shall show sufficient justification based on the following standards:

- (1) The relative harm to the parties if the stay is granted or denied,
- (2) The likelihood of the appellant's success on the merits,
- (3) The likelihood of immediate and irreparable harm if the stay is not granted, and
- (4) Whether the public interest favors granting the stay.

Please include your AMC serial number(s) on all correspondence. If additional information is required, please call RéAnn Myers at 602-417-9413.



Lucas Lucero
Deputy State Director
Lands, Minerals, and Energy Division

Enclosure

CLAIM OWNERS FOR AMC433906

ROBERT G DENBERRY 12207 NELS PETERS RD EVERETT WA 98208-5806

DAVID AND NELLIE DENBERRY 12503 ALEXANDER RD EVERETT WA 98204-5457

SENDER: COMPLETE THIS SECTION

- Complete items 1, 2, and 3.
- Print your name and address on the reverse so that we can return the card to you.
- Attach this card to the back of the mailpiece, or on the front if space permits.

1. Article Addressed to:

DAVID AND NELLIE DENBERRY
 12207 NELS PETERS RD
 EVERETT, WA 98208-5806

920/RM/AM433903



9590 9402 2536 6306 7993 67

2. Article Number (Transfer from service label)

7010 2780 0003 1128 9803

COMPLETE THIS SECTION ON DELIVERY

A. Signature

X

 Agent Addressee

B. Received by (Printed Name)

C. Date of Delivery

12/27/17

 D. Is delivery address different from item 1? Yes
 If YES, enter delivery address below: No

3. Service Type

- Adult Signature
- Adult Signature Restricted Delivery
- Certified Mail®
- Certified Mail Restricted Delivery
- Collect on Delivery
- Collect on Delivery Restricted Delivery
- Insured Mail
- Insured Mail Restricted Delivery (over \$500)

- Priority Mail Express®
- Registered Mail™
- Registered Mail Restricted Delivery
- Return Receipt for Merchandise
- Signature Confirmation™
- Signature Confirmation Restricted Delivery

USPS TRACKING #

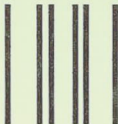
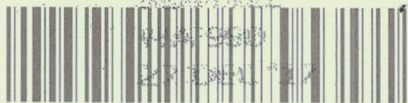

First-Class Mail
Postage & Fees Paid
USPS
Permit No. G-10

9590 9402 2536 6306 7993 67

United States
Postal Service

PHOENIX, ARIZONA

• Sender: Please print your name, address, and ZIP+4® in this box•

UNITED STATES

DEPARTMENT OF THE INTERIOR

Bureau of Land Management

Arizona State Office

One N. Central Avenue, Suite 800

Phoenix, AZ 85004-4427

2018 JAN - 3 A 10:44

RECEIVED
PHOENIX AZ STATE OFFICE

4-442700

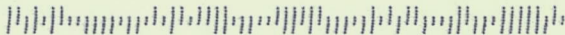



United States Department of the Interior

BUREAU OF LAND MANAGEMENT

Arizona State Office

One North Central Avenue, Suite 800

Phoenix, Arizona 85004-4427

www.blm.gov/az/



DEC 07 2017

In Reply Refer To:

3830 (9200) RM

AMC433903

CERTIFIED MAIL - RETURN RECEIPT REQUESTED No. 7017 0660 0000 3024 2864

DECISION

DAVID AND NELLIE DENBERRY : This decision affects those claims shown
12503 ALEXANDER RD : in the block below.
EVERETT, WA 98204-5457 :

AMC433906

TRINITY

MINING CLAIMS DECLARED FORFEITED

The mining claims listed above have been declared forfeited as of September 1, 2017, for failure to timely file the required maintenance fee payment or small miner's maintenance fee waiver (waiver).

Claimants are required to pay an annual non-refundable maintenance fee of \$155 per 20 acres or portion thereof, or submit a waiver, on or before September 1 of each year. These requirements were established by 30 U.S.C. 28f-1, as amended, and 43 CFR 3834 and 3835.

Our records do not show receipt of a maintenance fee payment or small miner waiver filed on or before the due date. Therefore, the claims listed above are forfeited.

Reclamation Requirements

This decision does not relieve you of the liability for reclamation of all areas disturbed by your activities on lands covered by the subject mining claim(s) and/or site(s). After you complete the reclamation, you must notify the authorized officer of the appropriate surface managing agency so that the authorized officer may conduct a final site inspection and determine whether you may be released from liability. If you fail to reclaim the land to the satisfaction of the authorized officer,

the surface management agency may cite you for noncompliance under its surface management regulations. For land administered by the Bureau of Land Management (BLM), if you fail to reclaim the land to the satisfaction of the authorized officer as required in 43 CFR Subpart 3809, BLM will issue an order of noncompliance under 43 CFR 3809.601(a). If you fail to comply with the non-compliance order, BLM may take further action under 43 CFR 3809.604. Failure to conduct reclamation is a prohibited act that may subject you to criminal penalties. See 43 CFR 3809.605(h) and 43 CFR 3809.700.

Appeal Procedures

This decision may be appealed to the Interior Board of Land Appeals, Office of the Secretary, in accordance with the regulations contained in 43 CFR, Part 4, and the enclosed Form 1842-1. If an appeal is taken, your notice of appeal must be filed in this office (at the above address) within 30 days from receipt of this decision. The appellant has the burden of showing that the decision appealed from is in error.

If you wish to file a petition pursuant to regulation 43 CFR 4.21 (58 FR 4939, January 19, 1993) for a stay of the effectiveness of this decision during the time that your appeal is being reviewed by the Board, the petition for a stay must accompany your notice of appeal. A petition for a stay is required to show sufficient justification based on the standards listed below. Copies of the notice of appeal and petition for a stay **must** also be submitted to each party named in this decision and to the Interior Board of Land Appeals and to the appropriate Office of the Solicitor (see 43 CFR 4.413) at the same time the original documents are filed with this office. If you request a stay, you have the burden of proof to demonstrate that a stay should be granted.

Standards for Obtaining a Stay

Except as otherwise provided by law or other pertinent regulation, a petition for a stay of a decision pending appeal shall show sufficient justification based on the following standards:

- (1) The relative harm to the parties if the stay is granted or denied,
- (2) The likelihood of the appellant's success on the merits,
- (3) The likelihood of immediate and irreparable harm if the stay is not granted, and
- (4) Whether the public interest favors granting the stay.

Please include your AMC serial number(s) on all correspondence. If additional information is required, please call RéAnn Myers at 602-417-9413.

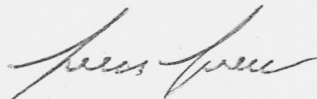

Lucas Lucero
Deputy State Director
Lands, Minerals, and Energy Division

Enclosure

CLAIM OWNERS FOR AMC433906

ROBERT G DENBERRY	12207 NELS PETERS RD	EVERETT	WA 98208-5806
DAVID AND NELLIE DENBERRY	12503 ALEXANDER RD	EVERETT	WA 98204-5457

UNITED STATES
 DEPARTMENT OF THE INTERIOR
 Bureau of Land Management
 Arizona State Office
 One North Central Avenue, Suite 800
 Phoenix, Arizona 85004-4427

OFFICIAL BUSINESS
 PENALTY FOR PRIVATE USE \$300

RECEIVED
 CLM AZ STATE OFFICE
 2017 DEC 18 P 9:00
 PHOENIX, ARIZONA



7017 0660 0000 3024 2864

heappost
 12/08/2017
 US POSTAGE



FIRST-CLASS MAIL

\$06.77⁰

US OFFICIAL MAIL
 \$300 Penalty
 For Private Use
 ZIP 85004
 041L11101433

DAVID AND NELLIE DENBERRY
 12503 ALEXANDER RD
 EVERETT WA 98204-5457

850 NFE 1 71610012/11/17
 FORWARD TIME EXP RTN TO SEND
 DENBERRY
 12207 NELS PETERS RD
 EVERETT WA 98208-5806

RETURN TO SENDER

98204-5457

PLACE STICKER AT TOP OF ENVELOPE TO THE RIGHT
 OF THE RETURN ADDRESS, FOR A POSTAGE LINE

SENDER: COMPLETE THIS SECTION

- Complete items 1, 2, and 3.
- Print your name and address on the reverse so that we can return the card to you.
- Attach this card to the back of the mailpiece, or on the front if space permits.

1. Article Addressed to:

DAVID AND NELLIE DENBERRY
 12503 ALEXANDER RD
 EVERETT WA 98204-5457
 9200 RM AMC433903



9590 9402 2629 6336 6620 05

2. Article Number (Transfer from service label)

7017 0660 0000 3024 2864

COMPLETE THIS SECTION ON DELIVERY

A. Signature

X

- Agent
- Addressee

B. Received by (Printed Name)

C. Date of Delivery

D. Is delivery address different from item 1? Yes
 If YES, enter delivery address below: No

3. Service Type

- Adult Signature
- Adult Signature Restricted Delivery
- Certified Mail®
- Certified Mail Restricted Delivery
- Collect on Delivery
- Collect on Delivery Restricted Delivery
- Priority Mail Express®
- Registered Mail™
- Registered Mail Restricted Delivery
- Return Receipt for Merchandise
- Signature Confirmation™
- Signature Confirmation Restricted Delivery

Track Another Package +

Tracking Number: 70102780000311289803

Remove X

Expected Delivery on

WEDNESDAY

27 DECEMBER 2017 ⓘ by **8:00pm** ⓘ

 **Delivered**

December 27, 2017 at 9:37 am
Delivered, Left with Individual
EVERETT, WA 98208

Get Updates ∨

Text & Email Updates



Tracking History



Product Information



See Less ^

Can't find what you're looking for?

Go to our FAQs section to find answers to your tracking questions.



United States Department of the Interior

BUREAU OF LAND MANAGEMENT
Arizona State Office
One North Central Avenue, Suite 800
Phoenix, Arizona 85004-4427
www.blm.gov/az/



In Reply Refer To:
3833 (9200) RM
AMC433903

MAR 14 2016

CERTIFIED MAIL - RETURN RECEIPT REQUESTED No. 7015 3010 0000 3945 0967

NOTICE

JASON KARPOWICH : This Notice Affects the Claims
PO BOX 3780 SITE 315 : Shown in the Block Below.
MESQUITE, NV 89024-3780 :

AMC433905
SAMOA EAST

No Rights Acquired on Portions of Lode Claim(s)

Pursuant to Title 43 Code of Federal Regulations 3832.1, this office received your notice(s) of location for recordation of mining claims. However, portions of the lode mining claim(s) listed above appear to lie within lands that are not open to location for the following reason:

Mineral Patent-Lode, Document No. 35405, issued May 3, 1902.

Therefore, although the claim(s) has/have been recorded, you have acquired no rights on any portion of the subject mining claim(s) that lie within these lands. Enclosed for reference is a copy of the Master Title Plat.

If additional information is required, please contact RéAnn Myers at 602-417-9413. Please include your AMC serial number(s) on all correspondence.

Rebecca Heick

Rebecca Heick
Deputy State Director
Lands, Minerals and Energy Division

Enclosure



USPS Tracking®



[Customer Service >](#)
Have questions? We're here to help.



[Get Easy Tracking Updates >](#)
Sign up for My USPS.

Tracking Number: 70153010000039450967

Product & Tracking Information

Postal Product:

Features:
Certified Mail™

Available Actions

[Text Updates](#)

[Email Updates](#)

DATE & TIME	STATUS OF ITEM	LOCATION
March 19, 2016 , 8:52 am	Delivered, To Agent	MESQUITE, NV 89024
Your item has been delivered to an agent at 8:52 am on March 19, 2016 in MESQUITE, NV 89024.		
March 18, 2016 , 10:02 am	Available for Pickup	MESQUITE, NV 89024
March 18, 2016 , 1:59 am	Departed USPS Facility	LAS VEGAS, NV 89199
March 17, 2016 , 1:41 pm	Arrived at USPS Facility	LAS VEGAS, NV 89199
March 17, 2016 , 8:12 am	Departed USPS Facility	PHOENIX, AZ 85026
March 16, 2016 , 8:41 pm	Arrived at USPS Facility	PHOENIX, AZ 85026

Track Another Package

Tracking (or receipt) number

[Track It](#)

Manage Incoming Packages

Track all your packages from a dashboard.
No tracking numbers necessary.

[Sign up for My USPS >](#)



HELPFUL LINKS

- [Contact Us](#)
- [Site Index](#)
- [FAQs](#)

ON ABOUT.USPS.COM

- [About USPS Home](#)
- [Newsroom](#)
- [USPS Service Updates](#)
- [Forms & Publications](#)
- [Government Services](#)
- [Careers](#)

OTHER USPS SITES

- [Business Customer Gateway](#)
- [Postal Inspectors](#)
- [Inspector General](#)
- [Postal Explorer](#)
- [National Postal Museum](#)
- [Resources for Developers](#)

LEGAL INFORMATION

- [Privacy Policy](#)
- [Terms of Use](#)
- [FOIA](#)
- [No FEAR Act EEO Data](#)

SENDER: COMPLETE THIS SECTION

- Complete items 1, 2, and 3.
- Print your name and address on the reverse so that we can return the card to you.
- Attach this card to the back of the mailpiece, or on the front if space permits.

1. Article Addressed to:

DEPARTMENT OF LAND TRANSFER
 INFORMATION INC
 942 CALLE AMANECER STE B
 SAN CLEMENTE, CA 92673
 920/IR/AMC433903



9590 9402 1200 5246 9661 06

2. Article Number (Transfer from service label)

7015 1660 0000 0432 7923

COMPLETE THIS SECTION ON DELIVER

A. Signature

X

[Handwritten Signature]

- Agent
- Addressee

B. Received by (Printed Name)

Christina Lowe

C. Date of Delivery

2-10

D. Is delivery address different from item 1?
If YES, enter delivery address below:

- Yes
- No

3. Service Type

- Adult Signature
- Adult Signature Restricted Delivery
- Certified Mail®
- Certified Mail Restricted Delivery
- Collect on Delivery
- Collect on Delivery Restricted Delivery

- Priority Mail Express®
- Registered Mail™
- Registered Mail Restricted Delivery
- Return Receipt for Merchandise
- Signature Confirmation™
- Signature Confirmation Restricted Delivery

fail
fail Restricted Delivery
(0)

USPS TRACKING #



First-Class Mail
Postage & Fees Paid
USPS
Permit No. G-10

9590 9402 1200 5246 9661 06

United States
Postal Service

• Sender: Please print your name, address, and ZIP+4® in this box•

UNITED STATES
DEPARTMENT OF THE INTERIOR
Bureau of Land Management
Arizona State Office
One N. Central Avenue, Suite 800
Phoenix, AZ 85004-4427

RECEIVED
BLM AT STATE OFFICE

2016 FEB 17 P 2:31

PHOENIX, ARIZONA





United States Department of the Interior

BUREAU OF LAND MANAGEMENT

Arizona State Office

One North Central Avenue, Suite 800

Phoenix, Arizona 85004-4427

www.blm.gov/az/

FEB 05 2016



In Reply Refer To:
3800 (9200) IR
AMC433903

CERTIFIED MAIL – RETURN RECEIPT REQUESTED 7015 1660 0000 0432 7923

NOTICE

DEPARTMENT OF LAND TRANSFER
INFORMATION INC
942 CALLE AMANECER STE B
SAN CLEMENTE, CA 92673

:
:
:

This Decision Affects Those Claims
Shown in the Block Below.

AMC433904
ROOSEVELT MINE

Transfer(s) Not Processed

A conveyance document to transfer ownership of the mining claim(s) listed above was received by the Bureau of Land Management (BLM) Arizona State Office. The transfer(s) of ownership cannot be processed for the following reason(s):

The Quitclaim Deed must be acknowledged before a Notary Public. Please correct the Quitclaim Deed by having the document acknowledged and stamped before a Notary Public on the same day.

If appropriate, please submit a corrected conveyance document, required documents, or additional fees, within 30 days of your receipt of this notice. If the required information is not received within the 30-day timeframe, no further action will be taken, and the BLM will retain the non-refundable processing fees submitted.

If additional information is required, please contact Iran Reyman at 602-417-9355. Please include your AMC serial number(s) on all correspondence.

Rebecca Heick
Deputy State Director
Lands, Minerals and Energy Division

SENDER: COMPLETE THIS SECTION

- Complete items 1, 2, and 3.
- Print your name and address on the reverse so that we can return the card to you.
- Attach this card to the back of the mailpiece, or on the front if space permits.

1. Article Addressed to:

DEPARTMENT OF LAND TRANSFER
INFORMATION INC
942 CALLE AMANECER STE B
SAN CLEMENTE, CA 92673
920/IR/AMC433903



9590 9402 1200 5246 9661 06

2. Article Number (Transfer from service label)

7015 1660 0000 0432 7923

COMPLETE THIS SECTION ON DELIVERY

A. Signature

X *Paul*

- Agent
- Addressee

B. Received by (Printed Name)

Christina Lowe

C. Date of Delivery

2-10

D. Is delivery address different from item 1? Yes
If YES, enter delivery address below: No

3. Service Type

- Adult Signature
- Adult Signature Restricted Delivery
- Certified Mail®
- Certified Mail Restricted Delivery
- Collect on Delivery
- Collect on Delivery Restricted Delivery
- Mail Restricted Delivery
- Priority Mail Express®
- Registered Mail™
- Registered Mail Restricted Delivery
- Return Receipt for Merchandise
- Signature Confirmation™
- Signature Confirmation Restricted Delivery

PS Form 3811, July 2015 PSN 7530-02-000-9053

Domestic Return Receipt

USPS TRACKING#

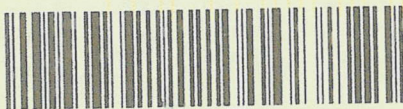

9590 9402 1200 5246 9661 06

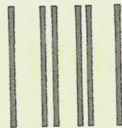

First-Class Mail
Postage & Fees Paid
USPS
Permit No. G-10

United States
Postal Service

• Sender: Please print your name, address, and ZIP+4® in this box•

UNITED STATES
DEPARTMENT OF THE INTERIOR
Bureau of Land Management
Arizona State Office
One N. Central Avenue, Suite 800
Phoenix, AZ 85004-4427

RECEIVED
DLM A
2016 FEB 11 PM
PHOENIX, ARIZONA

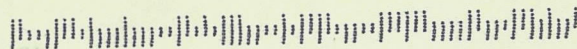

NOTICE!!

These documents have been scanned!

Do not place un-scanned documents beneath this notice!

Do not remove this notice from this file!

GPO Jacket No. 560-102
Print Order 61540
Rise Business Services, LLC
Job=AZ15 5/8/2019



Box Number= AZ15023



Claim Begin-End: AMC433903-AMC433906

3 Transfers



AZ15023-10

AMC433804-AMC434503



DEPARTMENT OF LAND TRANSFER INFORMATION

PROTECTING AMERICA'S RESOURCES

WWW.LANDTRANSFER.US.COM

942 CALLE AMANECER SUITE A
SAN CLEMENTE, CA 92673

TEL 949.361.6618
FAX 949.366.9945

433903

January 20, 16

Bureau of Land Management
Arizona State Office
One Central Avenue
Suite 800
Phoenix, AZ 85004-4427

RE: Mining Claim Change of Ownership/Quitclaim Deed to be processed

To Whom It May Concern:

Enclosed, please find a Mining Claim Change of Ownership Request in the form of Legal Quitclaim Deed to be processed.

Also attached you will find my check for payment in the amount of \$10.00 for the processing of this Quitclaim Deed.

Should you need any additional information, please do not hesitate to call on me.

Warmest Regards,

Recording Department
949.361.6618

RECEIVED
BLM ARIZONA STATE OFFICE
2016 JAN 25 P 3:03
PHOENIX, ARIZONA

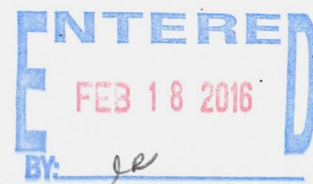

RECORDING REQUESTED BY:

(Mail Recorded Document To;)

Department of Land Transfer Inc.

942 Calle Amanecer, Suite B

San Clemente, CA 92673

(Mail Tax Statements To;)

Kenneth Quackenbush

34 Morris Dr

PO Box 160

South Fallsburg, NY 12779

FOR RECORDER'S USE

UNPATENTED MINING CLAIM QUITCLAIM DEED

NOTICE IS HEREBY GIVEN that Department of Land Transfer Information, Inc., a Wyoming Corporation whose current mailing address is 942 Calle Amanecer, Suite B, San Clemente, CA 92673 (collectively, "GRANTOR"), in consideration of money received and other good and valuable consideration, do hereby remise, release and forever quitclaim to; Kenneth Quackenbush, whose mailing address is 34 Morris Dr., PO Box 160, South Fallsburg, NY 12779 (collectively, "Grantee"), all rights, title and interest of Grantor, in and to the following mining claim; The **ROOSEVELT MINE** lode mining claim, **AMC433904**. The general course of this claim is East and West and it is situated in the Gila-Salt River Meridian, Yavapai County, Arizona. This claim is 1,500 feet in length and 600 feet in width. This claim runs from the location monument on which this location notice is posted approximately 1,200 feet in an Easterly direction to the East end line and approximately 300 feet in a Southerly direction to the South end line. This claim is marked by four (4) monuments, one at each corner of the claim. Additionally, there are two (2) end-line markers on each side of the center of the claim. All markers are 4" x 4" posts that are buried 1.5' in the ground and protrude 4.5' above the ground embossed with the name of the claim and its location in relation to the claim. The location monument on which this notice is posted is situated within Section 18, Township 10N, Range 2E, Gila-Salt River Meridian, Yavapai County Arizona and this claim encompasses portions of the following quarter section (s), Township (s) and Range (s); S 1/2 of NE 1/4 of SW 1/4 and L5 of Section 18, T10N, R2E Gila-Salt River Meridian, Yavapai County Arizona. The locality of this claim with reference to some natural object or permanent monument and additional information (if any) concerning its locality are as follows: SE corner of this claim is SE corner of NE 1/4 of SW 1/4 Section 18, T10N, R2E.

Tax Exemption Code A6

IN WITNESS WHEREOF, this Mining Claim Quitclaim Deed is executed on January 19, 2016:
DEPARTMENT OF LAND TRANSFER INFORMATION, INC.

Steven L. Cyros, President

Authorized Officer for DEPARTMENT OF LAND TRANSFER INFORMATION, INC.

RECORDED
2016 JAN 25 2 3:03
DEPARTMENT OF LAND TRANSFER INFORMATION



Department of Land Transfer

942 Calle Amanecer
Bldg. B / MS 548
San Clemente, CA 92673

SANTA ANA, CA 926

22 JAN 2016 PM 2 L



RECEIVED
BLM AZ STATE OFFICE

2016 JAN 25 P 3:02

PHOENIX, ARIZONA

Bureau of Land Management
Arizona State Office
One Central Avenue
Suite 800
Phoenix, AZ 85004-4427

85004442760



Department of Land Transfer
942 Calle Amanecer
Bldg. B / MS 548
San Clemente, CA 92673

United States Department of the Interior
Bureau of Land Management
 LANDS/RECREATION & PLANNING
 ONE N CENTRAL AVE
 PHOENIX, AZ 85004 -2203
 Phone: 602-417-9200

Receipt

No: 3480130

Transaction #: 3580309	
Date of Transaction: 01/26/2016	
CUSTOMER:	
DEPARTMENT OF LAND TRANSFER INFORMATION INC 942 CALLE AMANECER STE B SAN CLEMENTE, CA 92673-6220 US	

LINE #	QTY	DESCRIPTION	REMARKS	UNIT PRICE	TOTAL
1	1.00	LOCATABLE MINERALS / MINING CLAIMS- NOT NEW-UNADJUD, ONE AUTH NO. ONLY / MINING CLAIM MONEY RECEIVED CASES: AMC433904/\$10.00	QCD - 1	- n/a -	10.00
TOTAL:					\$10.00

PAYMENT INFORMATION					
1	AMOUNT:	10.00	POSTMARKED:	01/22/2016	
	TYPE:	CHECK	RECEIVED:	01/25/2016	
	CHECK NO:	6527			
	NAME:	DEPARTMENT OF LAND TRANSFER INFORMATION 942 CALLE AMANECER STE B SAN CLEMENTE CA 92673-6220 US			

REMARKS

This receipt was generated by the automated BLM Collections and Billing System and is a paper representation of a portion of the official electronic record contained therein.



DEPARTMENT OF LAND TRANSFER INFORMATION

PROTECTING AMERICA'S RESOURCES

WWW.LANDTRANSFER.US.COM

942 CALLE AMANECER SUITE A
SAN CLEMENTE, CA 92673

TEL 949.361.6618
FAX 949.366.9945

RECEIVED
DLH ADJUTANT OFFICE
2016 FEB 17 P 2:51
PHOENIX, ARIZONA

February 10, 16

Bureau of Land Management
Arizona State Office
One Central Avenue
Suite 800
Phoenix, AZ 85004-4427

RE: (4 total) Mining Claim Change of Ownership/Quitclaim Deeds to be processed
3800 (9200) IR

Enclosed are the quitclaim deeds, notarized, and ready for transfer of ownership.

Should you need any additional information, please do not hesitate to call on me.

Warmest Regards,

Recording Department
949.361.6618



United States Department of the Interior

BUREAU OF LAND MANAGEMENT

Arizona State Office

One North Central Avenue, Suite 800

Phoenix, Arizona 85004-4427

www.blm.gov/az/

FEB 05 2016



RECEIVED
BLM ARIZONA STATE OFFICE
2016 FEB 17 P 2:52
PHOENIX, ARIZONA

In Reply Refer To:
3800 (9200) IR
AMC433903

CERTIFIED MAIL - RETURN RECEIPT REQUESTED 7015 1660 0000 0432 7923

NOTICE

DEPARTMENT OF LAND TRANSFER
INFORMATION INC
942 CALLE AMANECER STE B
SAN CLEMENTE, CA 92673

This Decision Affects Those Claims
Shown in the Block Below.

AMC433904	AMC 435 855	AMC 435 856	AMC 435 795
ROOSEVELT MINE	Littlehorn	Purple Pansy	Belmont

Transfer(s) Not Processed

A conveyance document to transfer ownership of the mining claim(s) listed above was received by the Bureau of Land Management (BLM) Arizona State Office. The transfer(s) of ownership cannot be processed for the following reason(s):

The Quitclaim Deed must be acknowledged before a Notary Public. Please correct the Quitclaim Deed by having the document acknowledged and stamped before a Notary Public on the same day.

If appropriate, please submit a corrected conveyance document, required documents, or additional fees, within 30 days of your receipt of this notice. If the required information is not received within the 30-day timeframe, no further action will be taken, and the BLM will retain the non-refundable processing fees submitted.

If additional information is required, please contact Iran Reyman at 602-417-9355. Please include your AMC serial number(s) on all correspondence.

Rebecca Heick
Deputy State Director
Lands, Minerals and Energy Division



Department of Land Transfer

942 Calle Amanecer
Bldg. B / MS 548
San Clemente, CA 92673

SANTA ANA, CA 92682
11 FEB 2016 PM 10 L



ATTN: 3800 (9200) IR

Bureau of Land Management
Arizona State Office
One Central Avenue
Suite 800
Phoenix, AZ 85004-4427

85004442700



Department of Land Transfer
942 Calle Amanecer
Bldg. B / MS 548
San Clemente, CA 92673

RECORDING REQUESTED BY:

(Mail Recorded Document To;)

Department of Land Transfer Inc.

942 Calle Amanecer, Suite B

San Clemente, CA 92673

(Mail Tax Statements To;)

Kenneth Quackenbush

34 Morris Dr

PO Box 160

South Fallsburg, NY 12779

FOR RECORDER'S USE

UNPATENTED MINING CLAIM QUITCLAIM DEED

NOTICE IS HEREBY GIVEN that Department of Land Transfer Information, Inc., a Wyoming Corporation whose current mailing address is 942 Calle Amanecer, Suite B, San Clemente, CA 92673 (collectively, "GRANTOR"), in consideration of money received and other good and valuable consideration, do hereby remise, release and forever quitclaim to; Kenneth Quackenbush, whose mailing address is 34 Morris Dr., PO Box 160, South Fallsburg, NY 12779 (collectively, "Grantee"), all rights, title and interest of Grantor, in and to the following mining claim; The **ROOSEVELT MINE** lode mining claim, **AMC433904**. The general course of this claim is East and West and it is situated in the Gila-Salt River Meridian, Yavapai County, Arizona. This claim is 1,500 feet in length and 600 feet in width. This claim runs from the location monument on which this location notice is posted approximately 1,200 feet in an Easterly direction to the East end line and approximately 300 feet in a Southerly direction to the South end line. This claim is marked by four (4) monuments, one at each corner of the claim. Additionally, there are two (2) end-line markers on each side of the center of the claim. All markers are 4" x 4" posts that are buried 1.5' in the ground and protrude 4.5' above the ground embossed with the name of the claim and its location in relation to the claim. The location monument on which this notice is posted is situated within Section 18, Township 10N, Range 2E, Gila-Salt River Meridian, Yavapai County Arizona and this claim encompasses portions of the following quarter section (s), Township (s) and Range (s); S 1/2 of NE 1/4 of SW 1/4 and L5 of Section 18, T10N, R2E Gila-Salt River Meridian, Yavapai County Arizona. The locality of this claim with reference to some natural object or permanent monument and additional information (if any) concerning its locality are as follows: SE corner of this claim is SE corner of NE 1/4 of SW 1/4 Section 18, T10N, R2E.

Tax Exemption Code A6

IN WITNESS WHEREOF, this Mining Claim Quitclaim Deed is executed on February 10, 2016:

DEPARTMENT OF LAND TRANSFER INFORMATION, INC.

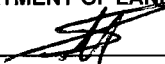

Steven L. Cyros, President

Authorized Officer for DEPARTMENT OF LAND TRANSFER INFORMATION, INC.

A notary public or other officer completing this certificate verifies only the identity of the individual who signed the document to which this certificate is attached, and not the truthfulness, accuracy, or validity of that document.

ACKNOWLEDGMENT

STATE OF CALIFORNIA

COUNTY OF ORANGE, SS:

On Feb 10, 2016, before me, James Pak, notary public, personally appeared Steven L. Cyros, who proved to me on the basis of satisfactory evidence to be the person(s) whose names(s) is/are subscribed to the within instrument and acknowledged to me that he/she/they executed the same in his/her/their authorized capacity(ies), and that but his/her/their signatures(s) on the instrument the person(s), or the entity upon behalf of which the person(s) acted, executed the instrument.

I certify under PENALTY OF PERJURY under the laws of State of California that the foregoing paragraph is true and correct.

WITNESS my hand and official seal.

Signature  (SEAL)

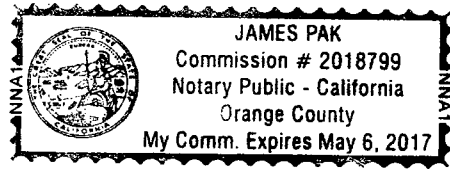



AMC 433903
DEPARTMENT OF LAND TRANSFER INFORMATION

PROTECTING AMERICA'S RESOURCES

WWW.LANDTRANSFER.US.COM

942 CALLE AMANECER SUITE A
SAN CLEMENTE, CA 92673

TEL 949.361.6618

FAX 949.366.9945

December 30, 15

Bureau of Land Management
Arizona State Office
One Central Avenue
Suite 800
Phoenix, AZ 85004-4427

RE: Mining Claim Change of Ownership/Quitclaim Deed to be processed

To Whom It May Concern:

Enclosed, please find a Mining Claim Change of Ownership Request in the form of Legal Quitclaim Deed to be processed.

Also attached you will find my check for payment in the amount of \$10.00 for the processing of this Quitclaim Deed.

Should you need any additional information, please do not hesitate to call on me.

Warmest Regards,

Recording Department
949.361.6618

RECEIVED
BLM ARIZONA OFFICE
2016 JAN -6 P 3:16
PHOENIX, ARIZONA

ENTERED INTO COMPUTER

01/22/2016 DJJ

RECORDING REQUESTED BY:

(Mail recording to;)

Department of Land Transfer
Information, Inc.

942 Calle Amanecer, Suite B

San Clemente, CA

92673

FOR RECORDER'S USE

UNPATENTED MINING CLAIM QUITCLAIM DEED

NOTICE IS HEREBY GIVEN that Department of Land Transfer Information, Inc., a Wyoming Corporation whose current mailing address is 942 Calle Amanecer, Suite B, San Clemente, CA 92673 (collectively, "GRANTOR"), in consideration of money received and other good and valuable consideration, do hereby remise, release and forever quitclaim to; Jason Karpowich, whose mailing address PO BOX 3780 Site 315, Mesquite NV, 89024 (collectively, "Grantee"), all rights, title and interest of Grantor, in and to the following mining claim; The **SAMOA EAST** lode mining claim, **AMC433905**. The general course of this claim is East and West and it is situated in the Gila Salt River Meridian, Mohave County, Arizona. This claim is 1,500 feet in length and 600 feet in width. This claim runs from the location monument on which this location notice is posted approximately 1,200 feet in an Easterly direction to the East end line and approximately 300 feet in a Southerly direction to the South end line. This claim is marked by four (4) monuments, one at each corner of the claim. Additionally, there are two (2) end-line markers on each side of the center of the claim. All markers are 4" x 4" posts that are buried 1.5' in the ground and protrude 4.5' above the ground embossed with the name of the claim and its location in relation to the claim. The location monument on which this notice is posted is situated within Section 1, Township 23N, Range 18W, Gila Salt River Meridian, Mohave County Arizona and this claim encompasses portions of the following quarter section (s), Township (s) and Range (s); NE 1/4 of SE 1/4 Section 1, T23N, R18W, SE 1/4 of SE 1/4 Section 1, T23N, R18W, NW 1/4 of SW 1/4 Section 6, T23N, R17W and SW 1/4 of SW 1/4 Section 6, T23N, R17W, Gila Salt River Meridian, Mohave County Arizona. The locality of this claim with reference to some natural object or permanent monument and additional information (if any) concerning its locality are as follows: SW corner of this claim is 920 Feet North and 870 Feet West of the SE corner of Section 1, T23N, R18W.

ARS 11-1134 Exemption Code – A6 (Unpatented Mining Claim)

IN WITNESS WHEREOF, this Mining Claim Quitclaim Deed is executed on December 30, 2015:

DEPARTMENT OF LAND TRANSFER INFORMATION, INC.

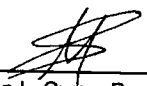

Steven L. Cyrus, President

Authorized Officer for DEPARTMENT OF LAND TRANSFER INFORMATION, INC.

RECEIVED
PLM / RECORDS
OFFICE
2016 JAN - 6 P 3: 16
PHOENIX, ARIZONA



Department of Land Transfer

942 Calle Amanecer
Bldg. B / MS 548
San Clemente, CA 92673

RECEIVED
BLM AZ STATE OFFICE

2016 JAN -6 P 2:57

PHOENIX, ARIZONA



Bureau of Land Management
Arizona State Office
One Central Avenue
Suite 800
Phoenix, AZ 85004-4427

85004442700



Department of Land Transfer
942 Calle Amanecer
Bldg. B / MS 548
San Clemente, CA 92673

United States Department of the Interior
Bureau of Land Management
 LANDS/RECREATION & PLANNING
 ONE N CENTRAL AVE
 PHOENIX, AZ 85004 -2203
 Phone: 602-417-9200

Receipt

No: 3469274

Transaction #: 3569225	
Date of Transaction: 01/07/2016	
CUSTOMER:	
DEPARTMENT OF LAND TRANSFER INFORMATION INC 942 CALLE AMANECER STE B SAN CLEMENTE, CA 92673-6220 US	

LINE #	QTY	DESCRIPTION	REMARKS	UNIT PRICE	TOTAL
1	1.00	LOCATABLE MINERALS / MINING CLAIMS- NOT NEW-UNADJUD, ONE AUTH NO. ONLY / MINING CLAIM MONEY RECEIVED CASES: AMC433905/\$10.00	QCD - 1	- n/a -	10.00
TOTAL:					\$10.00

PAYMENT INFORMATION			
1	AMOUNT:	10.00	POSTMARKED: 12/30/2015
	TYPE:	CHECK	RECEIVED: 01/06/2016
	CHECK NO:	6466	
	NAME:	DEPARTMENT OF LAND TRANSFER INFORMATION 942 CALLE AMANECER STE B SAN CLEMENTE CA 92673-6220 US	

REMARKS

This receipt was generated by the automated BLM Collections and Billing System and is a paper representation of a portion of the official electronic record contained therein.



DEPARTMENT OF LAND TRANSFER INFORMATION

PROTECTING AMERICA'S RESOURCES

WWW.LANDTRANSFER.US.COM

942 CALLE AMANECER SUITE A
SAN CLEMENTE, CA 92673

TEL 949.361.6618
FAX 949.366.9945

AMC 433903

November 9, 15

Bureau of Land Management
Arizona State Office
One Central Avenue
Suite 800
Phoenix, AZ 85004-4427

RE: Mining Claim Change of Ownership/Quitclaim Deed to be processed

To Whom It May Concern:

Enclosed, please find a Mining Claim Change of Ownership Request in the form of Legal Quitclaim Deed to be processed.

Also attached you will find my check for payment in the amount of \$30.00 for the processing of this Quitclaim Deed.

Should you need any additional information, please do not hesitate to call on me.

Warmest Regards,

Recording Department
949.361.6618

RECEIPT #

3432958

RECEIVED
BLM ARIZONA OFFICE
2015 NOV 13 P 2:58
PHOENIX, ARIZONA

ENTERED INTO COMPUTER

12/17/15 *EGJ*

RECORDING REQUESTED BY:

(Mail recording to;)

Department of Land Transfer

Information Inc.

942 Calle Amanecer Suite A

San Clemente, CA

92673

FOR RECORDER'S USE

UNPATENTED MINING CLAIM QUITCLAIM DEED

NOTICE IS HEREBY GIVEN that Department of Land Transfer Information, Inc., a Wyoming Corporation whose current mailing address is 942 Calle Amanecer, Suite B, San Clemente, CA 92673 (collectively, "GRANTOR"), in consideration of money received and other good and valuable consideration, do hereby remise, release and forever quitclaim to; Joe Jicha, Jeannie Jicha, and 4J Prospecting LLC, whose mailing address is PO Box 729, Maricopa AZ, 85139 collectively, "Grantee"), all rights, title and interest of Grantor, in and to the following mining claim; The **BUTTE** lode mining claim, **AMC433903**. The general course of this claim is East and West and it is situated in the Gila Salt River Meridian, Maricopa County, Arizona. This claim is 1,500 feet in length and 600 feet in width. This claim runs from the location monument on which this location notice is posted approximately 1,200 feet in an Easterly direction to the East end line and approximately 300 feet in a Southerly direction to the South end line. This claim is marked by four (4) monuments, one at each corner of the claim. Additionally, there are two (2) end-line markers on each side of the center of the claim. All markers are 4" x 4" wooden posts that are buried 1.5' in the ground and protrude 4.5' above the ground embossed with the name of the claim and its location in relation to the claim. The location monument on which this notice is posted is situated within Section 28, Township 2S, Range 9W, Gila Salt River Meridian, Maricopa County Arizona and this claim encompasses portions of the following quarter section (s), Township (s) and Range (s); S 1/2 of NE 1/4 of SE 1/4 and NW 1/4 of SE 1/4 of Section 28, T2S, R9W, Gila Salt River Meridian, Maricopa County Arizona. The locality of this claim with reference to some natural object or permanent monument and additional information (if any) concerning its locality are as follows: SE corner of this claim is the SE corner of NE 1/4 of SE 1/4 of Section 28, T2S, R9W.

Exempt per code A.R.S. 11-1134 A4

IN WITNESS WHEREOF, this Mining Claim Quitclaim Deed is executed on November 6, 2015:

DEPARTMENT OF LAND TRANSFER INFORMATION, INC.

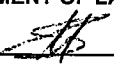
Steven L. Cyros, President

Authorized Officer for DEPARTMENT OF LAND TRANSFER INFORMATION, INC.

RECEIVED
BLM & BUREAU OF LAND MANAGEMENT
2015 NOV 13 P 2:58
PHOENIX, ARIZONA



Department of Land Transfer

942 Calle Amanecer
Bldg. B / MS 548
San Clemente, CA 92673

RECEIVED
BLM AZ STATE OFFICE

2015 NOV 13 P 2:57

PHOENIX, ARIZONA

SANTA ANA CA 926

10 NOV 2015 PHO 1



Bureau of Land Management
Arizona State Office
One Central Avenue
Suite 800
Phoenix, AZ 85004-4427

85004442700



Department of Land Transfer
942 Calle Amanecer
Bldg. B / MS 548
San Clemente, CA 92673

**United States Department of the Interior
Bureau of Land Management**

LANDS/RECREATION & PLANNING

ONE N CENTRAL AVE
PHOENIX, AZ 85004 -2203
Phone: 602-417-9200

Receipt

No: 3432958

Transaction #: 3532060	
Date of Transaction: 11/16/2015	
CUSTOMER:	
DEPARTMENT OF LAND TRANSFER INFORMATION INC 942 CALLE AMANECER STE B SAN CLEMENTE, CA 92673-6220 US	

LINE #	QTY	DESCRIPTION	REMARKS	UNIT PRICE	TOTAL
1	1.00	LOCATABLE MINERALS / MINING CLAIMS- NOT NEW-UNADJUD, ONE AUTH NO. ONLY / MINING CLAIM MONEY RECEIVED CASES: AMC433903/\$30.00	QCD - 3	- n/a -	30.00
TOTAL:					\$30.00

PAYMENT INFORMATION					
1	AMOUNT:	30.00	POSTMARKED:	11/10/2015	
	TYPE:	CHECK	RECEIVED:	11/13/2015	
	CHECK NO:	6371			
	NAME:	DEPARTMENT OF LAND TRANSFER INFORMATION 942 CALLE AMANECER STE B SAN CLEMENTE CA 92673-6220 US			

REMARKS

This receipt was generated by the automated BLM Collections and Billing System and is a paper representation of a portion of the official electronic record contained therein.

MC 433903

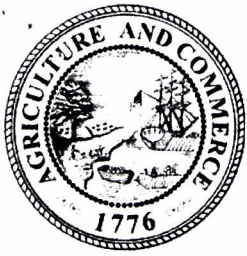

DEPARTMENT OF LAND TRANSFER INFORMATION

PROTECTING AMERICA'S RESOURCES

WWW.LANDTRANSFER.US.COM

942 CALLE AMANECER SUITE A
SAN CLEMENTE, CA 92673

TEL 949.361.6618

FAX 949.366.9945

November 19, 15

Bureau of Land Management
Arizona State Office
One Central Avenue
Suite 800
Phoenix, AZ 85004-4427

RE: Mining Claim Change of Ownership/Quitclaim Deed to be processed

To Whom It May Concern:

Enclosed, please find a Mining Claim Change of Ownership Request in the form of Legal Quitclaim Deed to be processed.

Also attached you will find my check for payment in the amount of \$30.00 for the processing of this Quitclaim Deed.

Should you need any additional information, please do not hesitate to call on me.

Warmest Regards,

Recording Department
949.361.6618

RECEIVED
2015 NOV 23 P 3:12
PHOENIX, ARIZONA

ENTERED INTO COMPUTER

12/17/15 DJJ

RECORDING REQUESTED BY:
(AND WHEN RECORDED MAIL DOCUMENT AND
TAX STATEMENT TO;)

Department of Land Transfer Inc.
942 Calle Amanecer, Suite B
San Clemente, CA
92673

FOR RECORDER'S USE

UNPATENTED MINING CLAIM QUITCLAIM DEED

NOTICE IS HEREBY GIVEN that Department of Land Transfer Information, Inc., a Wyoming Corporation whose current mailing address is 942 Calle Amanecer, Suite B, San Clemente, CA 92673 (collectively, "GRANTOR"), in consideration of money received and other good and valuable consideration, do hereby remise, release and forever quitclaim to; Robert Glenn Denberry, David Denberry, and Nellie Denberry, whose mailing address is 12503 Alexander Rd., Everett WA, 98204 (collectively, "Grantee"), all rights, title and interest of Grantor, in and to the following mining claim; The **TRINITY** lode mining claim, **AMC433906**. The general course of this claim is East and West and it is situated in the Gila Salt River Meridian, La Paz County, Arizona. This claim is 1,500 feet in length and 600 feet in width. This claim runs from the location monument on which this location notice is posted approximately 1,200 feet in an Easterly direction to the East end line and approximately 300 feet in a Southerly direction to the South end line. This claim is marked by four (4) monuments, one at each corner of the claim. Additionally, there are two (2) end-line markers on each side of the center of the claim. All markers are 4" x 4" posts that are buried 1.5' in the ground and protrude 4.5' above the ground embossed with the name of the claim and its location in relation to the claim. The location monument on which this notice is posted is situated within Section 8, Township 4N, Range 13W, Gila Salt River Meridian, La Paz County Arizona and this claim encompasses portions of the following quarter section (s), Township (s) and Range (s); NW 1/4 of NE 1/4, NE 1/4 of NE 1/4, SW 1/4 of NE 1/4 and SE 1/4 of NE 1/4 of Section 8, T4N, R13W, Gila Salt River Meridian, La Paz County Arizona. The locality of this claim with reference to some natural object or permanent monument and additional information (if any) concerning its locality are as follows: NW corner of this claim is 300 Feet North and 750 Feet West of the NE corner of SE 1/4 of NE 1/4 of Section 8, T4N, R13W.

EXEMPT CODE A.R.S. 11-11134 A6 Unpatented Mining Claim

IN WITNESS WHEREOF, this Mining Claim Quitclaim Deed is executed on November 19, 2015:

DEPARTMENT OF LAND TRANSFER INFORMATION, INC.



Steven L. Cyros, President

Authorized Officer for DEPARTMENT OF LAND TRANSFER INFORMATION, INC.

RECORDED
2015 NOV 23 P 3:12
INDEXED



Department of Land Transfer

942 Calle Amanecer
Bldg. B / MS 548
San Clemente, CA 92673

SANTA ANA CA 926

19 NOV 2015 PM 7 L



RECEIVED
BLM ARIZONA STATE OFFICE

2015 NOV 23 P 3:09

PHOENIX, ARIZONA

Bureau of Land Management
Arizona State Office
One Central Avenue
Suite 800
Phoenix, AZ 85004-4427

85004442700



Department of Land Transfer
942 Calle Amanecer
Bldg. B / MS 548
San Clemente, CA 92673

United States Department of the Interior
Bureau of Land Management
 LANDS/RECREATION & PLANNING
 ONE N CENTRAL AVE
 PHOENIX, AZ 85004 -2203
 Phone: 602-417-9200

Receipt

No: 3438560

Transaction #: 3537804	
Date of Transaction: 11/24/2015	
CUSTOMER:	
DEPARTMENT OF LAND TRANSFER INFORMATION INC 942 CALLE AMANECER STE B SAN CLEMENTE, CA 92673-6220 US	

LINE #	QTY	DESCRIPTION	REMARKS	UNIT PRICE	TOTAL
1	1.00	LOCATABLE MINERALS / MINING CLAIMS- NOT NEW-UNADJUD, ONE AUTH NO. ONLY / MINING CLAIM MONEY RECEIVED CASES: AMC433906/\$30.00	QCD - 3	- n/a -	30.00
TOTAL:					\$30.00

PAYMENT INFORMATION					
1	AMOUNT:	30.00	POSTMARKED:	11/19/2015	
	TYPE:	CHECK	RECEIVED:	11/23/2015	
	CHECK NO:	6398			
	NAME:	DEPARTMENT OF LAND TRANSFER INFORMATION 942 CALLE AMANECER STE B SAN CLEMENTE CA 92673-6220 US			

REMARKS

This receipt was generated by the automated BLM Collections and Billing System and is a paper representation of a portion of the official electronic record contained therein.

NOTICE!!

These documents have been scanned!

Do not place un-scanned documents beneath this notice!

Do not remove this notice from this file!

GPO Jacket No. 560-102
Print Order 61540
Rise Business Services, LLC
Job=AZ15 5/8/2019



Box Number= AZ15023



Claim Begin-End: AMC433903-AMC433906

4 Annual Filings



AZ15023-10

AMC433804-AMC434503

DEPARTMENT OF THE INTERIOR
BUREAU OF LAND MANAGEMENT
MINING CLAIMS

Run Date/Time: 8/20/2018

MC Maintenance Fees Paid Through the BLM Pay Portal
(by Date Paid)

Page 235 Of 316

CBS Receipt: 4236477

Printed For Lead File # AMC433903

Agency Tracking ID: 1534348537

Assessment Year: 2019

Paid On: 8/15/2018

Number of BLM Serial Nr: 3

Total Amount Paid: \$465.00

Claim Name	BLM Serial No	Lead File No	Amount Paid
BUTTE	AMC433903	AMC433903	\$155.00
YELLOW MEDICINE	AMC443764	AMC443764	\$155.00
DESERT ROSE	AMC444989	AMC444988	\$155.00

**United States Department of the Interior
Bureau of Land Management
BUSINESS & SUPPORT SVCS DIV
ONE N CENTRAL AVE SUITE 800
PHOENIX, AZ 85004 -4427
Phone: 602-417-9200**

Receipt

No: 4236477

Transaction #: 4351849	
Date of Transaction: 08/15/2018	
CUSTOMER:	
JOSEPH A JICHA P.O. BOX 729 MARICOPA, AZ 85139 US	

LINE #	QTY	DESCRIPTION	REMARKS	UNIT PRICE	TOTAL
1	1.00	LOCATABLE MINERALS / MINING CLAIMS- NOT NEW-UNADJUD, ONE AUTH NO. ONLY / MINING CLAIM MONEY RECEIVED CASES: AMC433903/\$465.00		- n/a -	465.00
TOTAL:					\$465.00

PAYMENT INFORMATION				
NOTE: Items will appear on credit card statement as "BLM O Mining Claim".				
1	AMOUNT:	465.00	POSTMARKED:	N/A
	TYPE:	CREDIT CARD	RECEIVED:	08/15/2018
	NAME:	JOSEPH A JICHA P.O. BOX 729 MARICOPA AZ 85139 US		
	CARD NO:	XXXXXXXXXXXX2785	AUTH CODE:	077663
	NAME ON CARD:	JOSEPH A JICHA		
	SIGNATURE:			

REMARKS

This receipt was generated by the automated BLM Collections and Billing System and is a paper representation of a portion of the official electronic record contained therein.

Run Date: 07/23/18

Run Time: 04:31 PM

**DEPARTMENT OF THE INTERIOR
BUREAU OF LAND MANAGEMENT
MINING CLAIMS**

MC Maintenance Fees Paid Through the BLM Pay Portal

CBS Receipt: 4193455

Printed For Lead File # AMC433903

Agency Tracking ID: 1529453543

Assessment Year: 2019

Number of BLM Serial Nr: 3

Paid On: 06/19/2018

Total Amount Paid: \$465.00

Claim Name	BLM Serial No	Lead File No	Amount Paid
ROOSEVELT MINE	AMC433904	AMC433903	\$155.00
TIGER GOLD #3	AMC435141	AMC435141	\$155.00
ARIZONA KING	AMC437286	AMC437285	\$155.00

**United States Department of the Interior
Bureau of Land Management
BUSINESS & SUPPORT SVCS DIV
ONE N CENTRAL AVE SUITE 800
PHOENIX, AZ 85004 -4427
Phone: 602-417-9200**

Receipt

No: 4193455

Transaction #: 4308211	
Date of Transaction: 06/19/2018	
CUSTOMER:	
KENNETH QUACKENBUSH PO BOX 160 SOUTH FALLSBURG, NY 12779 US	

LINE #	QTY	DESCRIPTION	REMARKS	UNIT PRICE	TOTAL
1	1.00	LOCATABLE MINERALS / MINING CLAIMS- NOT NEW-UNADJUD, ONE AUTH NO. ONLY / MINING CLAIM MONEY RECEIVED CASES: AMC433904/\$465.00		- n/a -	465.00
TOTAL:					\$465.00

PAYMENT INFORMATION				
NOTE: Items will appear on credit card statement as "BLM O Mining Claim".				
1	AMOUNT:	465.00	POSTMARKED:	N/A
	TYPE:	CREDIT CARD	RECEIVED:	06/19/2018
	NAME:	KENNETH QUACKENBUSH PO BOX 160 SOUTH FALLSBURG NY 12779 US		
	CARD NO:	XXXXXXXXXXXX6343	AUTH CODE:	091612
	NAME ON CARD:	KENNETH QUACKENBUSH		
	SIGNATURE:			

REMARKS

This receipt was generated by the automated BLM Collections and Billing System and is a paper representation of a portion of the official electronic record contained therein.

Run Date: 08/14/17

Run Time: 01:28 PM

**DEPARTMENT OF THE INTERIOR
BUREAU OF LAND MANAGEMENT
MINING CLAIMS**

MC Maintenance Fees Paid Through the BLM Pay Portal

CBS Receipt: 3934132

Printed For Lead File # AMC433903

Agency Tracking ID: 1502569671

Assessment Year: 2018

Number of BLM Serial Nr: 1

Paid On: 08/12/2017

Total Amount Paid: \$155.00

Claim Name	BLM Serial No	Lead File No	Amount Paid
BUTTE	AMC433903	AMC433903	\$155.00

United States Department of the Interior
Bureau of Land Management
 BUSINESS & SUPPORT SVCS DIV
 ONE N CENTRAL AVE SUITE 800
 PHOENIX, AZ 85004 -4427
 Phone: 602-417-9200

Receipt

No: 3934132

Transaction #: 4043728	
Date of Transaction: 08/12/2017	
CUSTOMER:	
JOSEPH JICHA PO BOX 97 MARICOPA, AZ 85139 US	

LINE #	QTY	DESCRIPTION	REMARKS	UNIT PRICE	TOTAL
1	1.00	LOCATABLE MINERALS / MINING CLAIMS- NOT NEW-UNADJUD, ONE AUTH NO. ONLY / MINING CLAIM MONEY RECEIVED CASES: AMC433903/\$155.00		- n/a -	155.00
TOTAL:					\$155.00

PAYMENT INFORMATION			
NOTE: Items will appear on credit card statement as "BLM O Mining Claim".			
1	AMOUNT:	155.00	POSTMARKED: N/A
	TYPE:	CREDIT CARD	RECEIVED: 08/12/2017
	NAME:	JOSEPH JICHA PO BOX 97 MARICOPA AZ 85139 US	
	CARD NO:	XXXXXXXXXXXX9414	AUTH CODE: 012985
	NAME ON CARD:	JOSEPH JICHA	
	EXPIRES:	10/2019	
	SIGNATURE:		

REMARKS

This receipt was generated by the automated BLM Collections and Billing System and is a paper representation of a portion of the official electronic record contained therein.

Run Date: 05/02/17

Run Time: 10:58 AM

**DEPARTMENT OF THE INTERIOR
BUREAU OF LAND MANAGEMENT
MINING CLAIMS**

MC Maintenance Fees Paid Through the BLM Pay Portal

CBS Receipt: 3802080

Printed For Lead File # AMC433903

Agency Tracking ID: 1491148168

Assessment Year: 2018

Number of BLM Serial Nr: 3

Paid On: 04/02/2017

Total Amount Paid: \$465.00

Claim Name	BLM Serial No	Lead File No	Amount Paid
ROOSEVELT MINE	AMC433904	AMC433903	\$155.00
TIGER GOLD #3	AMC435141	AMC435141	\$155.00
PEACOCK GOLD #4	AMC435583	AMC435574	\$155.00

United States Department of the Interior
Bureau of Land Management
 BUSINESS & SUPPORT SVCS DIV
 ONE N CENTRAL AVE SUITE 800
 PHOENIX, AZ 85004 -4427
 Phone: 602-417-9200

Receipt

No: 3802080

Transaction #: 3909674	
Date of Transaction: 04/02/2017	
CUSTOMER:	
KENNETH QUACKENBUSH PO BOX 160 SOUTH FALLSBURG, NY 12779 US	

LINE #	QTY	DESCRIPTION	REMARKS	UNIT PRICE	TOTAL
1	1.00	LOCATABLE MINERALS / MINING CLAIMS- NOT NEW-UNADJUD, ONE AUTH NO. ONLY / MINING CLAIM MONEY RECEIVED CASES: AMC433904/\$465.00		- n/a -	465.00
TOTAL:					\$465.00

PAYMENT INFORMATION			
NOTE: Items will appear on credit card statement as "BLM O Mining Claim".			
1	AMOUNT:	465.00	POSTMARKED: N/A
	TYPE:	CREDIT CARD	RECEIVED: 04/02/2017
	NAME:	KENNETH QUACKENBUSH PO BOX 160 SOUTH FALLSBURG NY 12779 US	
	CARD NO:	XXXXXXXXXXXX3708	AUTH CODE: 005112
	NAME ON CARD:	KENNETH QUACKENBUSH	
	EXPIRES:	07/2020	
	SIGNATURE:		

REMARKS

This receipt was generated by the automated BLM Collections and Billing System and is a paper representation of a portion of the official electronic record contained therein.

Run Date: 07/19/16

Run Time: 03:13 PM

**DEPARTMENT OF THE INTERIOR
BUREAU OF LAND MANAGEMENT
MINING CLAIMS**

MC Maintenance Fees Paid Through the BLM Pay Portal

CBS Receipt: 3590672

Printed For Lead File # **AMC433903**

Agency Tracking ID: 1466610346

Assessment Year: 2017

Number of BLM Serial Nr: 1

Paid On: 06/22/2016

Total Amount Paid: \$155.00

Claim Name	BLM Serial No	Lead File No	Amount Paid
BUTTE	AMC433903	AMC433903	\$155.00

United States Department of the Interior
Bureau of Land Management
 BUSINESS & SUPPORT SVCS DIV
 ONE N CENTRAL AVE SUITE 800
 PHOENIX, AZ 85004 -4427
 Phone: (602) 417-9200

Receipt

No: 3590672

Transaction #: 3693851	
Date of Transaction: 06/22/2016	
CUSTOMER:	
JOSEPH JICHA 54107 W VISTA PRINCIPAL MARICOPA, AZ 85139 US	

LINE #	QTY	DESCRIPTION	REMARKS	UNIT PRICE	TOTAL
1	1.00	LOCATABLE MINERALS / MINING CLAIMS- NOT NEW-UNADJUD, ONE AUTH NO. ONLY / MINING CLAIM MONEY RECEIVED CASES: AMC433903/\$155.00		- n/a -	155.00
TOTAL:					\$155.00

PAYMENT INFORMATION			
NOTE: Items will appear on credit card statement as "BLM O Mining Claim".			
1	AMOUNT:	155.00	POSTMARKED: N/A
	TYPE:	CREDIT CARD	RECEIVED: 06/22/2016
	NAME:	JOSEPH JICHA 54107 W VISTA PRINCIPAL MARICOPA AZ 85139 US	
	CARD NO:	XXXXXXXXXXXX9456	AUTH CODE: 022361
	NAME ON CARD:	JOSEPH JICHA	
	EXPIRES:	12/2017	
	SIGNATURE:		

REMARKS

This receipt was generated by the automated BLM Collections and Billing System and is a paper representation of a portion of the official electronic record contained therein.

Run Date: 09/08/16

Run Time: 12:27 PM

**DEPARTMENT OF THE INTERIOR
BUREAU OF LAND MANAGEMENT
MINING CLAIMS**

MC Maintenance Fees Paid Through the BLM Pay Portal

CBS Receipt: 3637825

Printed For Lead File # AMC433903

Agency Tracking ID: 1471892608

Assessment Year: 2017

Number of BLM Serial Nr: 1

Paid On: 08/22/2016

Total Amount Paid: \$155.00

Claim Name	BLM Serial No	Lead File No	Amount Paid
TRINITY	AMC433906	AMC433903	\$155.00

**United States Department of the Interior
Bureau of Land Management
BUSINESS & SUPPORT SVCS DIV
ONE N CENTRAL AVE SUITE 800
PHOENIX, AZ 85004 -4427
Phone: (602) 417-9200**

Receipt

No: 3637825

Transaction #: 3741711	
Date of Transaction: 08/22/2016	
CUSTOMER:	
ROBERT DENBERRY 12207 NELS PETERS RD. EVERETT, WA 98208 US	

LINE #	QTY	DESCRIPTION	REMARKS	UNIT PRICE	TOTAL
1	1.00	LOCATABLE MINERALS / MINING CLAIMS- NOT NEW-UNADJUD, ONE AUTH NO. ONLY / MINING CLAIM MONEY RECEIVED CASES: AMC433906/\$155.00		- n/a -	155.00
TOTAL:					\$155.00

PAYMENT INFORMATION					
NOTE: Items will appear on credit card statement as "BLM O Mining Claim".					
1	AMOUNT:	155.00	POSTMARKED:	N/A	
	TYPE:	CREDIT CARD	RECEIVED:	08/22/2016	
	NAME:	ROBERT DENBERRY 12207 NELS PETERS RD. EVERETT WA 98208 US			
	CARD NO:	XXXXXXXXXXXX2919	AUTH CODE:	160486	
	NAME ON CARD:	ROBERT DENBERRY			
	EXPIRES:	08/2017			
	SIGNATURE:				

REMARKS

This receipt was generated by the automated BLM Collections and Billing System and is a paper representation of a portion of the official electronic record contained therein.

Run Date: 08/25/16

Run Time: 05:50 AM

**DEPARTMENT OF THE INTERIOR
BUREAU OF LAND MANAGEMENT
MINING CLAIMS**

MC Maintenance Fees Paid Through the BLM Pay Portal

CBS Receipt: 3629963

Printed For Lead File # **AMC433903**

Agency Tracking ID: 1471211900

Assessment Year: 2017

Number of BLM Serial Nr: 3

Paid On: 08/14/2016

Total Amount Paid: \$465.00

Claim Name	BLM Serial No	Lead File No	Amount Paid
ROOSEVELT MINE	AMC433904	AMC433903	\$155.00
TIGER GOLD #3	AMC435141	AMC435141	\$155.00
ARIZONA KING	AMC437286	AMC437285	\$155.00

United States Department of the Interior
Bureau of Land Management
 BUSINESS & SUPPORT SVCS DIV
 ONE N CENTRAL AVE SUITE 800
 PHOENIX, AZ 85004 -4427
 Phone: (602) 417-9200

Receipt

No: 3629963

Transaction #: 3733745	
Date of Transaction: 08/14/2016	
CUSTOMER:	
KENNETH QUACKENBUSH PO BOX 160 SOUTH FALLSBURG, NY 12779 US	

LINE #	QTY	DESCRIPTION	REMARKS	UNIT PRICE	TOTAL
1	1.00	LOCATABLE MINERALS / MINING CLAIMS- NOT NEW-UNADJUD, ONE AUTH NO. ONLY / MINING CLAIM MONEY RECEIVED CASES: AMC433904/\$465.00		- n/a -	465.00
TOTAL:					\$465.00

PAYMENT INFORMATION			
NOTE: Items will appear on credit card statement as "BLM O Mining Claim".			
1	AMOUNT:	465.00	POSTMARKED: N/A
	TYPE:	CREDIT CARD	RECEIVED: 08/14/2016
	NAME:	KENNETH QUACKENBUSH PO BOX 160 SOUTH FALLSBURG NY 12779 US	
	CARD NO:	XXXXXXXXXXXX3708	AUTH CODE: 070211
	NAME ON CARD:	KENNETH QUACKENBUSH	
	EXPIRES:	07/2020	
	SIGNATURE:		

REMARKS

This receipt was generated by the automated BLM Collections and Billing System and is a paper representation of a portion of the official electronic record contained therein.

Run Date: 09/09/16

Run Time: 05:54 AM

**DEPARTMENT OF THE INTERIOR
BUREAU OF LAND MANAGEMENT
MINING CLAIMS**

MC Maintenance Fees Paid Through the BLM Pay Portal

CBS Receipt: 3643467

Printed For Lead File # **AMC433903**

Agency Tracking ID: 1472219129

Number of BLM Serial Nr: 3

Assessment Year: 2017

Paid On: 08/26/2016

Total Amount Paid: \$620.00

Claim Name	BLM Serial No	Lead File No	Amount Paid
GOLDEN CROWN #12	AMC414389	AMC414381	\$310.00
DIAMOND JOE MINE	AMC429642	AMC429642	\$155.00
SAMOA EAST	AMC433905	AMC433903	\$155.00

United States Department of the Interior
Bureau of Land Management
 BUSINESS & SUPPORT SVCS DIV
 ONE N CENTRAL AVE SUITE 800
 PHOENIX, AZ 85004 -4427
 Phone: (602) 417-9200

Receipt

No: 3643467

Transaction #: 3747430	
Date of Transaction: 08/26/2016	
CUSTOMER:	
JASON KARPOWICH PO BOX 3780 SITE 315 MESQUITE, NV 89024 US	

LINE #	QTY	DESCRIPTION	REMARKS	UNIT PRICE	TOTAL
1	1.00	LOCATABLE MINERALS / MINING CLAIMS- NOT NEW-UNADJUD, ONE AUTH NO. ONLY / MINING CLAIM MONEY RECEIVED CASES: AMC414389/\$620.00		- n/a -	620.00
TOTAL:					\$620.00

PAYMENT INFORMATION			
NOTE: Items will appear on credit card statement as "BLM O Mining Claim".			
1	AMOUNT:	620.00	POSTMARKED: N/A
	TYPE:	CREDIT CARD	RECEIVED: 08/26/2016
	NAME:	JASON KARPOWICH PO BOX 3780 SITE 315 MESQUITE NV 89024 US	
	CARD NO:	XXXXXXXXXXXX0122	AUTH CODE: 026484
	NAME ON CARD:	JASON KARPOWICH	
	EXPIRES:	06/2019	
	SIGNATURE:		

REMARKS

This receipt was generated by the automated BLM Collections and Billing System and is a paper representation of a portion of the official electronic record contained therein.

NOTICE!!

These documents have been scanned!

Do not place un-scanned documents beneath this notice!

Do not remove this notice from this file!

GPO Jacket No. 560-102
Print Order 61540
Rise Business Services, LLC
Job=AZ15 5/8/2019



Box Number= AZ15023



Claim Begin-End: AMC433903-AMC433906

5 Miscellaneous



AZ15023-10

AMC433804-AMC434503



DEPARTMENT OF LAND TRANSFER INFORMATION
PROTECTING AMERICA'S RESOURCES

STEVEN L. CYROS
SUPERVISORY FIELD AGENT

942 CALLE AMANECER
BLDG. B / MS 548
SAN CLEMENTE, CA 92673
TEL (949) 366-9484
FAX (949) 366-9945
SCYROS@DLTI.US.COM
WWW.LANDTRANSFER.US.COM

October 9, 15

Bureau of Land Management
Arizona State Office
One Central Avenue
Suite 800
Phoenix, AZ 85004-4427

RE: Four (4) New Location Notice/Unpatented Mining Claim

To Whom It May Concern:

Enclosed, please find a check payable to Department of the Interior/BLM for payment in the amount of \$848.00 for four (4) new location notices for unpatented mining claims.

Should you need any additional information, please do not hesitate to call on me.

Warmest Regards,

Recording Department
949.361.6618

AMC433903

RECEIVED
BLM ARIZONA STATE OFFICE
2015 OCT 13 P 3:12
PHOENIX, ARIZONA

NOTICE!!

These documents have been scanned!

Do not place un-scanned documents beneath this notice!

Do not remove this notice from this file!

GPO Jacket No. 560-102
Print Order 61540
Rise Business Services, LLC
Job=AZ15 5/8/2019



Box Number= AZ15023



Claim Begin-End: AMC433903-AMC433906

6 Location Notices-Amendments and Supporting Documents



AZ15023-10

AMC433804-AMC434503

MINING CLAIM STATUS REPORT

Data Entered: 20 OCT 15

MTP Checked By: er

GEO Checked By: er

LEAD SERIAL NUMBER: AMC 433903 thru AMC 433906

NUMBER OF CLAIMS & TYPE:

4 LODE
 _____ PLACER
 _____ ASSOCIATION PLACER
 _____ MILL SITE
 _____ TUNNEL SITE

CHARGES:

Location Fee @ \$37 = \$ 148.00
 Processing Fee @ \$20 = \$ 80.00
 Maintenance Fee @ \$155 = \$ 620.00
 Add'l Maint Fee for Assoc Placer = \$ _____
SUBTOTAL \$ 848.00
 Other Fees \$ _____
 Other Fees \$ _____
TOTAL \$ 848.00

TOTAL ACREAGE: _____ Per Claim
(Placer Only)

NUMBER OF LOCATORS: _____

DOCUMENTS RECEIVED VIA: Over-the-Counter [] Mail [] TIMELY FILED: Yes [] No []

LEGAL DESCRIPTION:	T	<u>23</u>	R	<u>9W</u>	SEC	<u>28</u>
	T	<u>4N</u>	R	<u>13W</u>	SEC	<u>8</u>
	T	<u>10N</u>	R	<u>2E</u>	SEC	<u>18</u>
	T	<u>23N</u>	R	<u>18W</u>	SEC	<u>1</u>
	T	<u>23N</u>	R	<u>17W</u>	SEC	<u>6</u>

BLM [] FOREST SERVICE [] SUBJ TO PL 359: Yes [] No []
WILDERNESS AREA []

SPLIT ESTATE: N/A [] SX [] PX [] OTHER []
SRHA [] Was proper Notice filed if located on SHRA Land? Yes [] No []

RECONVEYED MINERALS ON BLM LAND REQUIRE OPENING ORDER FROM 1944 TO 1993:
Open to Entry On _____ N/A []

COMMENTS/STATUS: VOID [] PARTIALLY VOID [] PVT MINERALS [] WITHDRAWN LANDS []
OTHER []

AMC 433906 CORNER OF CLAIM TIED TO SECTION CORNER, SHOULD BE NE CORNER OF CLAIM NOT NW. USED MAP FOR DESCRIPTION. RM.

[] Claimant acknowledges that portions of the following claim(s) site(s) may be void or voidable.

Printed Name of Claimant _____ Signature of Claimant _____

*****FINAL ADJUDICATION*****

DATE 2/24/2016 INITIALS RM

AMC 433903

RECORDING REQUESTED BY:

(Mail recording to;)

Department of Land

Transfer Information, Inc.

942 Calle Amanecer, Suite B

San Clemente, CA 92673

FOR RECORDER'S USE

LOCATION NOTICE FOR LODE MINING CLAIM

NOTICE IS HEREBY GIVEN that the **BUTTE** lode mining claim has been located by Department of Land Transfer Information, Inc., a Wyoming Corporation whose current mailing address is 942 Calle Amanecer, Suite B, San Clemente, CA 92673.

The general course of this claim is East and West and it is situated in the Gila Salt River Meridian, Maricopa County, Arizona.

This claim is 1,500 feet in length and 600 feet in width. This claim runs from the location monument on which this location notice is posted approximately 1,200 feet in an Easterly direction to the East end line and approximately 300 feet in a Southerly direction to the South end line.

This claim is marked by four (4) monuments, one at each corner of the claim. Additionally, there are two (2) end-line markers on each side of the center of the claim. All markers are 4" x 4" posts that are buried 1.5' in the ground and protrude 4.5' above the ground embossed with the name of the claim and its location in relation to the claim.

The location monument on which this notice is posted is situated within Section 28, Township 2S, Range 9W, Gila Salt River Meridian, Maricopa County Arizona and this claim encompasses portions of the following quarter section (s), Township (s) and Range (s); S 1/2 of NE 1/4 of SE 1/4 and NW 1/4 of SE 1/4 of Section 28, T2S, R9W, Gila Salt River Meridian, Maricopa County Arizona.

The locality of this claim with reference to some natural object or permanent monument and additional information (if any) concerning its locality are as follows: SE corner of this claim is the SE corner of NE 1/4 of SE 1/4 of Section 28, T2S, R9W.

DATED AND POSTED on the ground this 5th day of September, 2015.

Locator of this lode mining claim is:

DEPARTMENT OF LAND TRANSFER INFORMATION, INC.



Steven L. Cyros, President

Authorized Officer for DEPARTMENT OF LAND TRANSFER INFORMATION,

PHOENIX, ARIZONA

2015 OCT 13 P 3:12

RECEIVED
BLM AZ STATE OFFICE

AMC433903

UNSURVEYED TOWNSHIP 2 SOUTH RANGE 9 WEST OF THE GILA AND SALT RIVER MERIDIAN, ARIZONA

PROTRACTION DIAGRAM NO 20 OFFICIALLY FILED 12/07/1959

MARICOPA COUNTY
LOWER SONORAN FIELD OFFICE

STATUS OF PUBLIC DOMAIN
LAND AND MINERAL TITLES

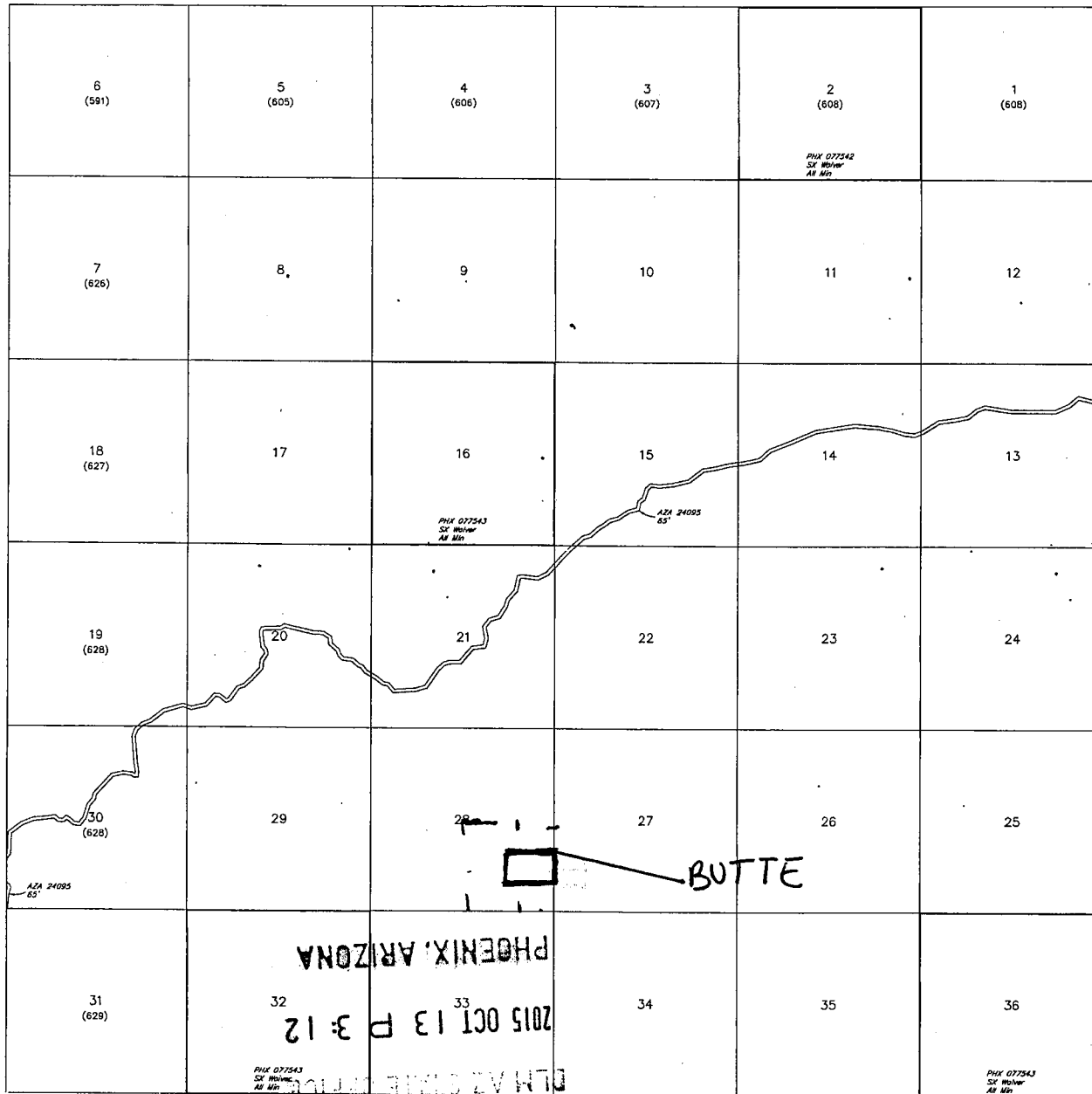

INDEX TO SEGREGATED TRACTS				
RESURVEY TRACT NO	ORIGINAL SURVEY			SUBDIVISION
	T	R	SEC	

FOR ORDERS AFFECTING DISPOSAL OR USE OF UNIDENTIFIED LANDS WITHDRAWN FOR CLASSIFICATION, MINERALS, WATER AND/OR OTHER PUBLIC PURPOSES, REFER TO INDEX OF MISCELLANEOUS DOCUMENTS.

Croazing Dist No 2
A 29183 R/W Weather Station 12.5'
Sec 20: W1/2
A 31830 R/W Rain Gauge 25.5'
Sec 1: S1/2SE1/4

PHOENIX, ARIZONA
2015 OCT 13 P 3:12
RECEIVED
DLN A/C FIELD OFFICE

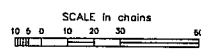

WARNING STATEMENT
This plot is the Bureau's Record of Title, and should be used only as a graphic display of the townships survey data. Records hereon do not reflect title changes which may have been affected by lateral movements of rivers or other bodies of water. Refer to the coastal surveys for official survey information.

CURRENT TO	NW	GSR Mer
3-21-2011	ACAD	T 2 S
		R 9 W

AMC433903

RECORDING REQUESTED BY:
(Mail recording to;)
Department of Land
Transfer Information, Inc.
942 Calle Amanecer, Suite B
San Clemente, CA 92673

FOR RECORDER'S USE

CERTIFICATE OF LOCATION FOR LODE MINING CLAIM

NOTICE IS HEREBY GIVEN that the **ROOSEVELT MINE** lode mining claim has been located by Department of Land Transfer Information, Inc., a Wyoming Corporation whose current mailing address is 942 Calle Amanecer, Suite B, San Clemente, CA 92673.

The general course of this claim is East and West and it is situated in the Gila-Salt River Meridian, Yavapai County, Arizona.

This claim is 1,500 feet in length and 600 feet in width. This claim runs from the location monument on which this location notice is posted approximately 1,200 feet in an Easterly direction to the East end line and approximately 300 feet in a Southerly direction to the South end line.

This claim is marked by four (4) monuments, one at each corner of the claim. Additionally, there are two (2) end-line markers on each side of the center of the claim. All markers are 4" x 4" posts that are buried 1.5' in the ground and protrude 4.5' above the ground embossed with the name of the claim and its location in relation to the claim.

The location monument on which this notice is posted is situated within Section 18, Township 10N, Range 2E, Gila-Salt River Meridian, Yavapai County Arizona and this claim encompasses portions of the following quarter section (s), Township (s) and Range (s); S 1/2 of NE 1/4 of SW 1/4 and L5 of Section 18, T10N, R2E Gila-Salt River Meridian, Yavapai County Arizona.

The locality of this claim with reference to some natural object or permanent monument and additional information (if any) concerning its locality are as follows: SE corner of this claim is SE corner of NE 1/4 of SW 1/4 Section 18, T10N, R2E.

DATED AND POSTED on the ground this 5th day of September, 2015.

Locator of this lode mining claim is:

DEPARTMENT OF LAND TRANSFER INFORMATION, INC.

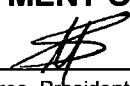
Steven L. Cyros, President
Authorized Officer for DEPARTMENT OF LAND TRANSFER INFORMATION, INC.

RECEIVED
BLM AZ STATE OFFICE
2015 OCT 13 P 3:12
PHOENIX, ARIZONA

AMC433904

TOWNSHIP 10 NORTH RANGE 2 EAST OF THE GILA AND SALT RIVER MERIDIAN, ARIZONA

YAVAPAI COUNTY
HAZZAYAMA FIELD OFFICE

STATUS OF PUBLIC DOMAIN
LAND AND MINERAL TITLES
AND ACQUIRED LANDS

INDEX TO SEGREGATED TRACTS				
RESURVEY TRACT NO	ORIGINAL SURVEY			SUBDIVISION
	T	R	SEC	

FOR ORDERS AFFECTING DISPOSAL OR USE OF UNIDENTIFIED LANDS WITHDRAWN FOR CLASSIFICATION, MINERALS, WATER AND/OR OTHER PUBLIC PURPOSES, REFER TO INDEX OF MISCELLANEOUS DOCUMENTS.

- MDS 40 NW
- 41 NW
- 43 SE
- 42 SW

A 9270 PL 359 Secs 6 & 7

A 22632 R/W 7.5'
Sec 5 : Lotz 3, 4, SE1/4NW1/4, E1/2SW1/4 M&B

AMC 314184, 314185 & 314187 PL 359 Sec 6

AMC 314637 - AMC 314640 PL 359 Secs 7, 18

AZA 22725 R/W
Sec 24 : W1/2W1/2NW1/4NW1/4

AZA 22224 R/W
Sec 33 : SW1/4SW1/4

AZA 22241 R/W
Sec 16 : SE1/4

AZA 22212 R/W
Sec 35 : NW1/4NW1/4NE1/4

AZA 22211 R/W
Sec 35 : NW1/4NE1/4

AZA 23641 R/W
Sec 5 : W1/2
Sec 17 : SW1/4NE1/4, E1/2NW1/4, SE1/4
Sec 20 : NE1/4NE1/4

AZA 23700-23
Deed of Taking
All Min
02-64-0154
D/C

Proc 7263
No Appo Frio
H&H

Lat 34°11'50"N
Long 112°05'20"W

CURRENT TO	CS	T
12-12-2008	PV	10 N
		R 2 E

WARNING STATEMENT
This plot is the Bureau's Record of Title, and should be used only as a graphic display of the townships survey data. Recordors do not reflect title changes which may have been effected by lateral movements of rivers or other bodies of water. Refer to the cadastral surveys for official survey information.

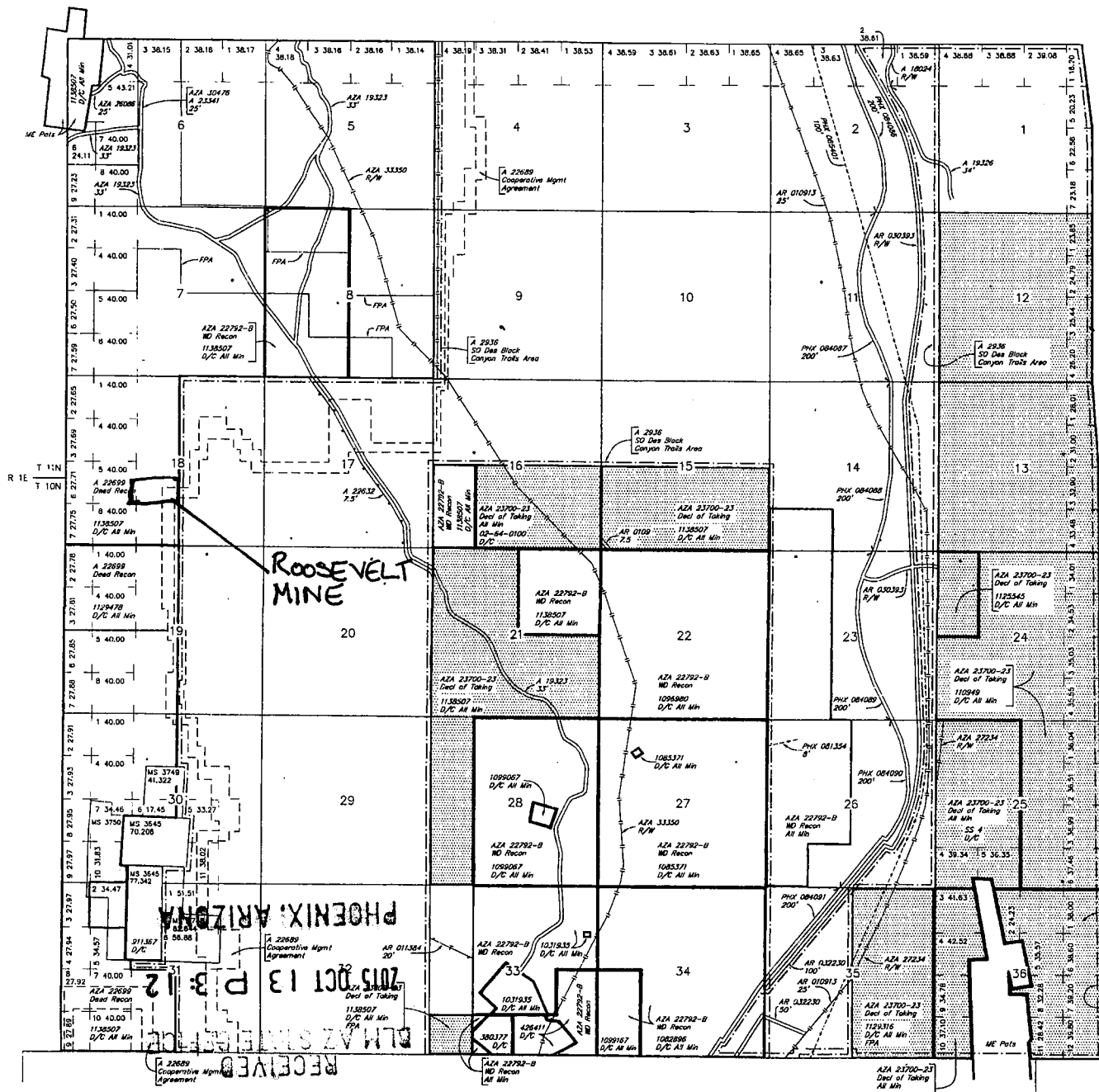

SCALE in chains
0 10 20 30 40

RECEIVED
2015 OCT 13 P. 12
PHOENIX, ARIZONA

AMC433904

RECORDING REQUESTED BY:

(Mail recording to;)

Department of Land
Transfer Information, Inc.
942 Calle Amanecer, Suite B
San Clemente, CA 92673

FOR RECORDER'S USE

LOCATION NOTICE FOR LODE MINING CLAIM

NOTICE IS HEREBY GIVEN that the **SAMOA EAST** lode mining claim has been located by Department of Land Transfer Information, Inc., a Wyoming Corporation whose current mailing address is 942 Calle Amanecer, Suite B, San Clemente, CA 92673.

The general course of this claim is East and West and it is situated in the Gila Salt River Meridian, Mohave County, Arizona.

This claim is 1,500 feet in length and 600 feet in width. This claim runs from the location monument on which this location notice is posted approximately 1,200 feet in an Easterly direction to the East end line and approximately 300 feet in a Southerly direction to the South end line.

This claim is marked by four (4) monuments, one at each corner of the claim. Additionally, there are two (2) end-line markers on each side of the center of the claim. All markers are 4" x 4" posts that are buried 1.5' in the ground and protrude 4.5' above the ground embossed with the name of the claim and its location in relation to the claim.

The location monument on which this notice is posted is situated within Section 1, Township 23N, Range 18W, Gila Salt River Meridian, Mohave County Arizona and this claim encompasses portions of the following quarter section (s), Township (s) and Range (s); NE 1/4 of SE 1/4 Section 1, T23N, R18W, SE 1/4 of SE 1/4 Section 1, T23N, R18W, NW 1/4 of SW 1/4 Section 6, T23N, R17W and SW 1/4 of SW 1/4 Section 6, T23N, R17W, Gila Salt River Meridian, Mohave County Arizona.

The locality of this claim with reference to some natural object or permanent monument and additional information (if any) concerning its locality are as follows: SW corner of this claim is 920 Feet North and 870 Feet West of the SE corner of Section 1, T23N, R18W.

DATED AND POSTED on the ground this 5th day of September, 2015.

Locator of this lode mining claim is:

DEPARTMENT OF LAND TRANSFER INFORMATION, INC.

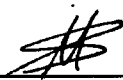

Steven L. Cyros, President
Authorized Officer for DEPARTMENT OF LAND TRANSFER INFORMATION, INC.

RECEIVED
BLM AZ STATE OFFICE
2015 OCT 13 P 3:13
PHOENIX, ARIZONA

AMC433905

MINING CLAIM MAP

- 1) Name of Claim; **SAMOA EAST**
- 2) Type if Claim; **LODE**
- 3) Location Monument is located in Section 1, Township 23N, Range 18W, Gila-Salt River Meridian, Mohave County, Arizona.
- 4) The types of corner and location monuments used are as follows: 4" X 4" Posts.

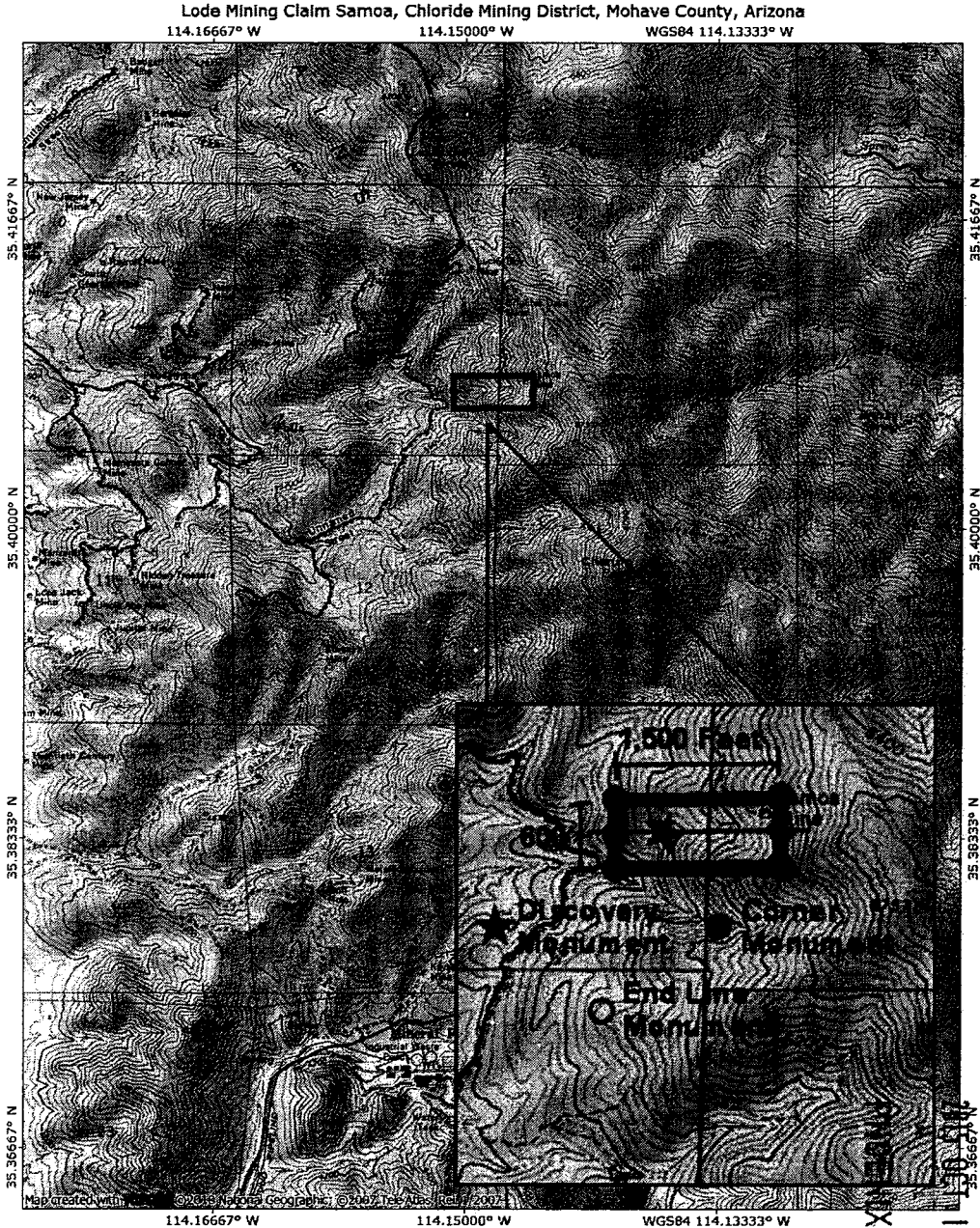

 NATIONAL GEOGRAPHIC



RECEIVED
 BLM AZ STATE OFFICE
 13P 3:13
 05/01/11
 MOHAVE COUNTY, ARIZONA

AMC433905

RECORDING REQUESTED BY:

(Mail recording to;)

Department of Land
Transfer Information, Inc.
942 Calle Amanecer, Suite B
San Clemente, CA 92673

FOR RECORDER'S USE

LOCATION NOTICE FOR LODE MINING CLAIM

NOTICE IS HEREBY GIVEN that the **TRINITY** lode mining claim has been located by Department of Land Transfer Information, Inc., a Wyoming Corporation whose current mailing address is 942 Calle Amanecer, Suite B, San Clemente, CA 92673.

The general course of this claim is East and West and it is situated in the Gila Salt River Meridian, La Paz County, Arizona.

This claim is 1,500 feet in length and 600 feet in width. This claim runs from the location monument on which this location notice is posted approximately 1,200 feet in an Easterly direction to the East end life and approximately 300 feet in a Southerly direction to the South end line.

This claim is marked by four (4) monuments, one at each corner of the claim. Additionally, there are two (2) end-line markers on each side of the center of the claim. All markers are 4" x 4" posts that are buried 1.5' in the ground and protrude 4.5' above the ground embossed with the name of the claim and its location in relation to the claim.

The location monument on which this notice is posted is situated within Section 8, Township 4N, Range 13W, Gila Salt River Meridian, La Paz County Arizona and this claim encompasses portions of the following quarter section (s), Township (s) and Range (s); NW 1/4 of NE 1/4, NE 1/4 of NE 1/4, SW 1/4 of NE 1/4 and SE 1/4 of NE 1/4 of Section 8, T4N, R13W, Gila Salt River Meridian, La Paz County Arizona.

The locality of this claim with reference to some natural object or permanent monument and additional information (if any) concerning its locality are as follows: NW corner of this claim is 300 Feet North and 750 Feet West of the NE corner of SE 1/4 of NE 1/4 of Section 8, T4N, R13W.

DATED AND POSTED on the ground this 5th day of September, 2015.

Locator of this lode mining claim is:

DEPARTMENT OF LAND TRANSFER INFORMATION, INC.

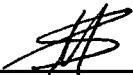

Steven L. Cyros, President
Authorized Officer for DEPARTMENT OF LAND TRANSFER INFORMATION, INC.

PHOENIX, ARIZONA

2015 OCT 13 P 3:12

RECEIVED
PLM AT STATE OFFICE

AMC433906

UNSURVEYED TOWNSHIP 4 NORTH RANGE 13 WEST OF THE GILA AND SALT RIVER MERIDIAN, ARIZONA

PROTRACTION DIAGRAM NO 19 OFFICIALLY FILED 12/07/1959

LA PAZ COUNTY
LAKE HAVASU FIELD OFFICE

AHC 433906

STATUS OF PUBLIC DOMAIN
LAND AND MINERAL TITLES

T 5N
R 13W R 12W

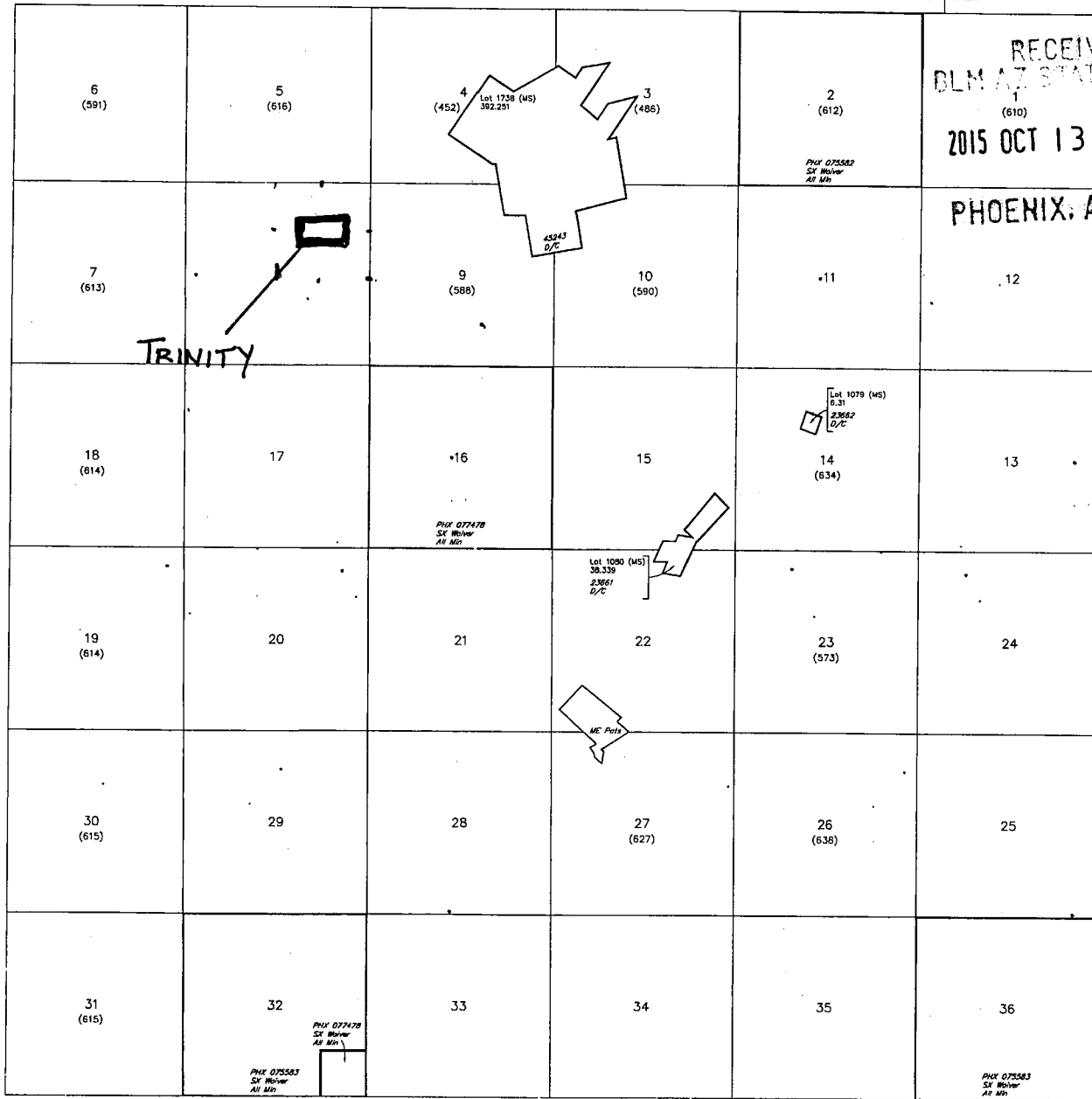

RECEIVED
BLM AZ STATE OFFICE
2015 OCT 13 P 3:12
PHOENIX, ARIZONA

INDEX TO SEGREGATED TRACTS				
RESURVEY	ORIGINAL SURVEY			
TRACT NO	T	R	SEC	SUBDIVISION

FOR ORDERS AFFECTING DISPOSAL OR USE OF UNIDENTIFIED LANDS WITHDRAWN FOR CLASSIFICATION, MINERALS, WATER AND/OR OTHER PUBLIC PURPOSES, REFER TO INDEX OF MISCELLANEOUS DOCUMENTS.

Grazing Dist No 2

MDS 364 NE
365 NW
366 SE

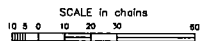

WARNING STATEMENT
This plot is the Bureau's Record of Title, and should be used only as a graphic display of the township survey data. Records hereon do not reflect title changes which may have been affected by lateral movements of rivers or other bodies of water. Refer to the cadastral surveys for official survey information.

CURRENT TO	NW	GSR Mer
9-5-2012	ACAD	T 4 N R 13 W

RUN TIME: 02:14 PM

RUN DATE: 10/20/2015

Page 1 of 1

DEPARTMENT OF INTERIOR
BUREAU OF LAND MANAGEMENT

Input Parameters for Geographic Report with Land

System Id = CR

Admin State = AZ

Geo State =

Casetype Begins With

Case Disp Txt = AUTHORIZED, CANCELLED, EXPIRED, PENDING, REJECTED, RELINQUISHED, WITHDRAWN

Mer Twp Rng =

Section =

Mtrs = 14 0100N 0020E 018, 14 0100N 0020E 999

Commodity =

Commodity Txt =

Pending Org =

Pend Org Decode =

Total Rows Returned: 14

NO WARRANTY IS MADE BY BLM FOR USE OF THE DATA
FOR PURPOSES NOT INTENDED BY BLM

RUN TIME: 02:13 PM

UNITED STATES DEPARTMENT OF INTERIOR
BUREAU OF LAND MANAGEMENT
GEOGRAPHIC REPORT WITH LAND
Sorted by Serial Number

RUN DATE: 10/20/2015

Page 1 of 2

Adm State: AZ

Serial Number: AZA 002936
Total Case Acres: 65,501.000

<u>Casetype</u>	<u>Case Disp</u>			<u>Sect</u>	<u>Sur Typ</u>	<u>Sur Num</u>	<u>Suff</u>	<u>Subdivision</u>	<u>Act Pend</u>
246100	AUTHORIZED	14	0100N	0020E	018	ALIQ		E2;	

Serial Number: AZA 022689
Total Case Acres: 2,161.980

<u>Casetype</u>	<u>Case Disp</u>			<u>Sect</u>	<u>Sur Typ</u>	<u>Sur Num</u>	<u>Suff</u>	<u>Subdivision</u>	<u>Act Pend</u>
206400	AUTHORIZED	14	0100N	0020E	018	ALIQ		NESWNE,SESWSWNE,W2SESWNE; W2NWSENE,SENWSENE; NESWSENE,W2SESENE; SESESENE,S2NESENE SENWSENESEW,E2SWSENESEW; SESENESEW,E2W2SESW,E2SESW; NENENESE,E2NWNWSE; NESWNWSE,S2NWSWNWSE; N2S2SWNWSE;	
							1		
							2		
							3		
							4		
							5		
							6		
							7		
							8		

Serial Number: AZA 022699PT
Total Case Acres: 12,382.940

<u>Casetype</u>	<u>Case Disp</u>			<u>Sect</u>	<u>Sur Typ</u>	<u>Sur Num</u>	<u>Suff</u>	<u>Subdivision</u>	<u>Act Pend</u>
221006	AUTHORIZED	14	0100N	0020E	018	ALIQ		E2W2; 1-8;	
								LOTS	

Serial Number: AZA 033821
Total Case Acres: 1.000

<u>Casetype</u>	<u>Case Disp</u>			<u>Sect</u>	<u>Sur Typ</u>	<u>Sur Num</u>	<u>Suff</u>	<u>Subdivision</u>	<u>Act Pend</u>
293200	EXPIRED	14	0100N	0020E	018	FF		PORTION OF;	

RUN TIME: 02:13 PM

UNITED STATES DEPARTMENT OF INTERIOR
BUREAU OF LAND MANAGEMENT
GEOGRAPHIC REPORT WITH LAND
Sorted by Serial Number

RUN DATE: 10/20/2015

Page 2 of 2

Adm State: AZ

Serial Number: AZA 036786

Total Case Acres: 1.000

<u>Casetype</u>	<u>Case Disp</u>				<u>Sect</u>	<u>Sur Typ</u>	<u>Sur Num</u>	<u>Suff</u>	<u>Subdivision</u>	<u>Act Pend</u>
371511	PENDING	14	0100N	0020E	018	FF			NESW(PART);	

RUN TIME: 02:17 PM

DEPARTMENT OF INTERIOR
BUREAU OF LAND MANAGEMENT

RUN DATE: 10/20/2015

Page 1 of 1

Input Parameters for Geographic Report with Land

System Id = CR

Admin State = AZ

Geo State =

Casetype Begins With

Case Disp Txt = AUTHORIZED, CANCELLED, EXPIRED, PENDING, REJECTED, RELINQUISHED, WITHDRAWN

Mer Twp Rng =

Section =

Mtrs = 14 0230N 0180W 001, 14 0230N 0180W 999

Commodity =

Commodity Txt =

Pending Org =

Pend Org Decode =

Total Rows Returned: 5

NO WARRANTY IS MADE BY BLM FOR USE OF THE DATA
FOR PURPOSES NOT INTENDED BY BLM

RUN TIME: 02:16 PM

Adm State: AZ

UNITED STATES DEPARTMENT OF INTERIOR
BUREAU OF LAND MANAGEMENT
GEOGRAPHIC REPORT WITH LAND
Sorted by Serial Number

RUN DATE: 10/20/2015

Page 1 of 1

Serial Number: AZA 007017
Total Case Acres: 378.790

<u>Casetype</u>	<u>Case Disp</u>	14	0230N	0180W	<u>Sect</u>	<u>Sur Typ</u>	<u>Sur Num</u>	<u>Suff</u>	<u>Subdivision</u>	<u>Act Pend</u>
281008	AUTHORIZED				001	LOTS			17,25;	

Serial Number: AZA 019995
Total Case Acres: 4.876

<u>Casetype</u>	<u>Case Disp</u>	14	0230N	0180W	<u>Sect</u>	<u>Sur Typ</u>	<u>Sur Num</u>	<u>Suff</u>	<u>Subdivision</u>	<u>Act Pend</u>
285003	AUTHORIZED				001	LOTS			19;	

Serial Number: AZA 028681
Total Case Acres: 5.210

<u>Casetype</u>	<u>Case Disp</u>	14	0230N	0180W	<u>Sect</u>	<u>Sur Typ</u>	<u>Sur Num</u>	<u>Suff</u>	<u>Subdivision</u>	<u>Act Pend</u>
286001	AUTHORIZED				001	MNR		1	SWSWSW;	

Serial Number: AZPHX 0034352
Total Case Acres: 424.177

<u>Casetype</u>	<u>Case Disp</u>	14	0230N	0180W	<u>Sect</u>	<u>Sur Typ</u>	<u>Sur Num</u>	<u>Suff</u>	<u>Subdivision</u>	<u>Act Pend</u>
285003	AUTHORIZED				001	ALIQ LOTS			S2SW,SWSE; 31;	

RUN TIME: 02:59 PM

DEPARTMENT OF INTERIOR
BUREAU OF LAND MANAGEMENT

RUN DATE: 10/20/2015
Page 1 of 1

Input Parameters for Geographic Report with Land

System Id = CR

Admin State = AZ

Geo State =

Casetype Begins With

Case Disp Txt = AUTHORIZED, CANCELLED, EXPIRED, PENDING, REJECTED, RELINQUISHED, WITHDRAWN

Mer Twp Rng =

Section =

Mtrs = 14 0230N 0170W 006, 14 0230N 0170W 999

Commodity =

Commodity Txt =

Pending Org =

Pend Org Decode =

Total Rows Returned: 0

NO WARRANTY IS MADE BY BLM FOR USE OF THE DATA
FOR PURPOSES NOT INTENDED BY BLM

RUN TIME: 02:58 PM

Adm State:

**UNITED STATES DEPARTMENT OF INTERIOR
BUREAU OF LAND MANAGEMENT
GEOGRAPHIC REPORT WITH LAND
Sorted by Serial Number**

RUN DATE: 10/20/2015

Page 1 of 1

RUN TIME: 02:22 PM

DEPARTMENT OF INTERIOR
BUREAU OF LAND MANAGEMENT

RUN DATE: 10/20/2015
Page 1 of 1

Input Parameters for Geographic Report with Land

System Id = CR

Admin State = AZ

Geo State =

Casetype Begins With

Case Disp Txt = AUTHORIZED, CANCELLED, EXPIRED, PENDING, REJECTED, RELINQUISHED, WITHDRAWN

Mer Twp Rng =

Section =

Mtrs = 14 0040N 0130W 008, 14 0040N 0130W 999

Commodity =

Commodity Txt =

Pending Org =

Pend Org Decode =

Total Rows Returned: 0

NO WARRANTY IS MADE BY BLM FOR USE OF THE DATA
FOR PURPOSES NOT INTENDED BY BLM

RUN TIME: 02:20 PM

Adm State:

UNITED STATES DEPARTMENT OF INTERIOR
BUREAU OF LAND MANAGEMENT
GEOGRAPHIC REPORT WITH LAND
Sorted by Serial Number

RUN DATE: 10/20/2015

Page 1 of 1

RUN TIME: 02:11 PM

RUN DATE: 10/20/2015

Page 1 of 1

DEPARTMENT OF INTERIOR
BUREAU OF LAND MANAGEMENT

Input Parameters for Geographic Report with Land

System Id = CR

Admin State = AZ

Geo State =

Casetype Begins With

Case Disp Txt = AUTHORIZED, CANCELLED, EXPIRED, PENDING, REJECTED, RELINQUISHED, WITHDRAWN

Mer Twp Rng =

Section =

Mtrs = 14 0020S 0090W 028, 14 0020S 0090W 999

Commodity =

Commodity Txt =

Pending Org =

Pend Org Decode =

Total Rows Returned: 0

NO WARRANTY IS MADE BY BLM FOR USE OF THE DATA
FOR PURPOSES NOT INTENDED BY BLM

RUN TIME: 02:09 PM

Adm State:

**UNITED STATES DEPARTMENT OF INTERIOR
BUREAU OF LAND MANAGEMENT
GEOGRAPHIC REPORT WITH LAND
Sorted by Serial Number**

RUN DATE: 10/20/2015

Page 1 of 1

UNSURVEYED TOWNSHIP 2 SOUTH RANGE 9 WEST OF THE GILA AND SALT RIVER MERIDIAN, ARIZONA

PROTRACTION DIAGRAM NO 20 OFFICIALLY FILED 12/07/1959

MARICOPA COUNTY
LOWER SONORAN FIELD OFFICE

STATUS OF PUBLIC DOMAIN
LAND AND MINERAL TITLES

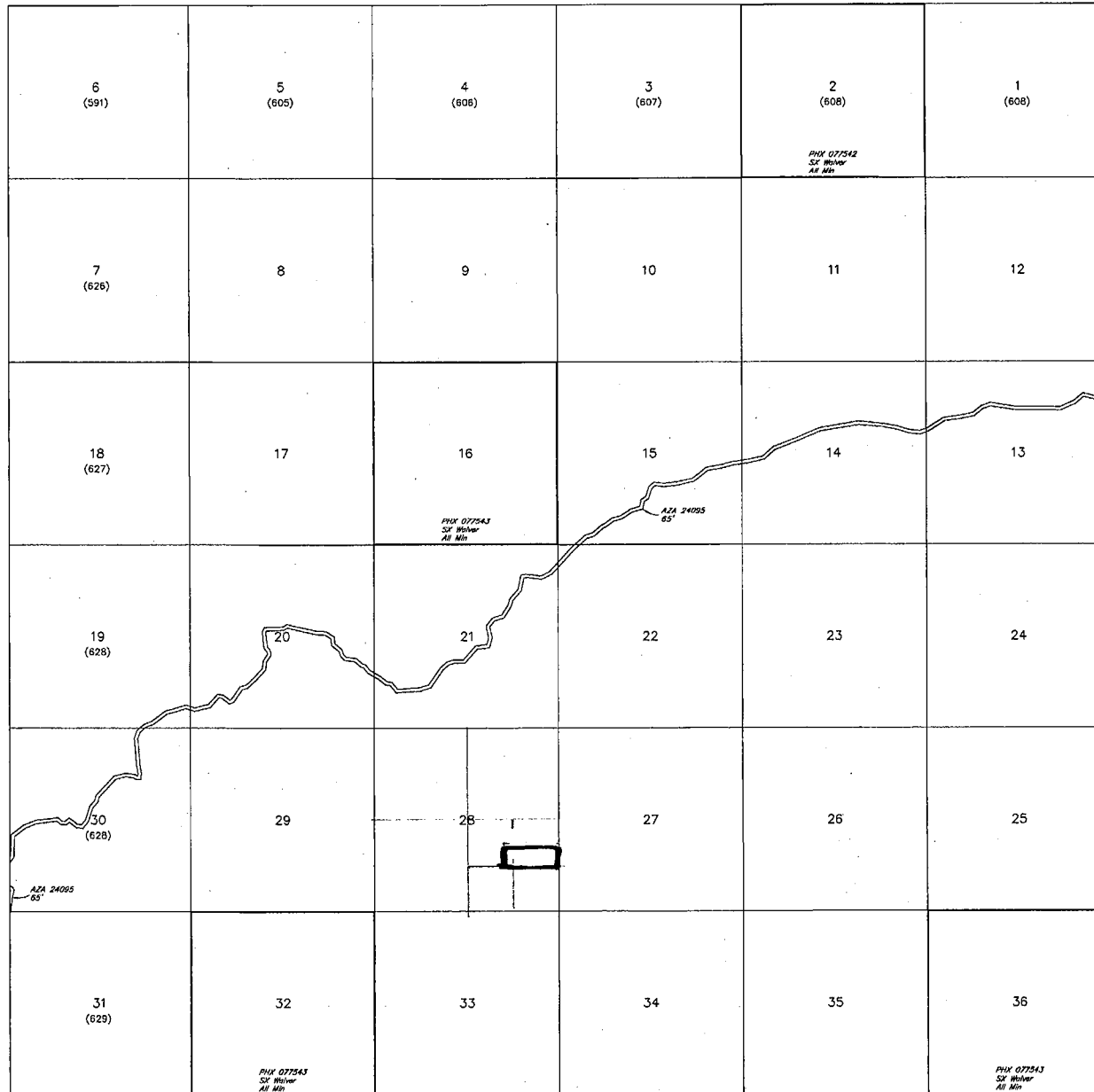

INDEX TO SEGREGATED TRACTS				
RESURVEY		ORIGINAL SURVEY		
TRACT NO	T	R	SEC	SUBDIVISION

FOR ORDERS AFFECTING DISPOSAL OR USE OF UNIDENTIFIED LANDS WITHDRAWN FOR CLASSIFICATION, MINERALS, WATER AND/OR OTHER PUBLIC PURPOSES, REFER TO INDEX OF MISCELLANEOUS DOCUMENTS.

Grazing Dist No 2

A 29183 R/W Weather Station 12.5'
Sec 20: W1/2

A 31830 R/W Rain Gauge 25.5'
Sec 1: S1/2SE1/4

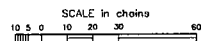

WARNING STATEMENT
This plot is the Bureau's Record of Title and should be used only as a graphic display of the township survey data. Recordation do not reflect title changes which may have been effected by lateral movements of rivers or other bodies of water. Refer to the cadastral surveys for official survey information.

R 9W R 8W
T 3S

CURRENT TO	NW	GSR Mer
3-21-2011	ACAD	T 2 S
		R 9 W

UNSURVEYED TOWNSHIP 4 NORTH RANGE 13 WEST OF THE GILA AND SALT RIVER MERIDIAN, ARIZONA

PROTRACTION DIAGRAM NO 19 OFFICIALLY FILED 12/07/1959

LA PAZ COUNTY
LAKE HAVASU FIELD OFFICE

T 5N
R 13W R 12W

STATUS OF PUBLIC DOMAIN
LAND AND MINERAL TITLES

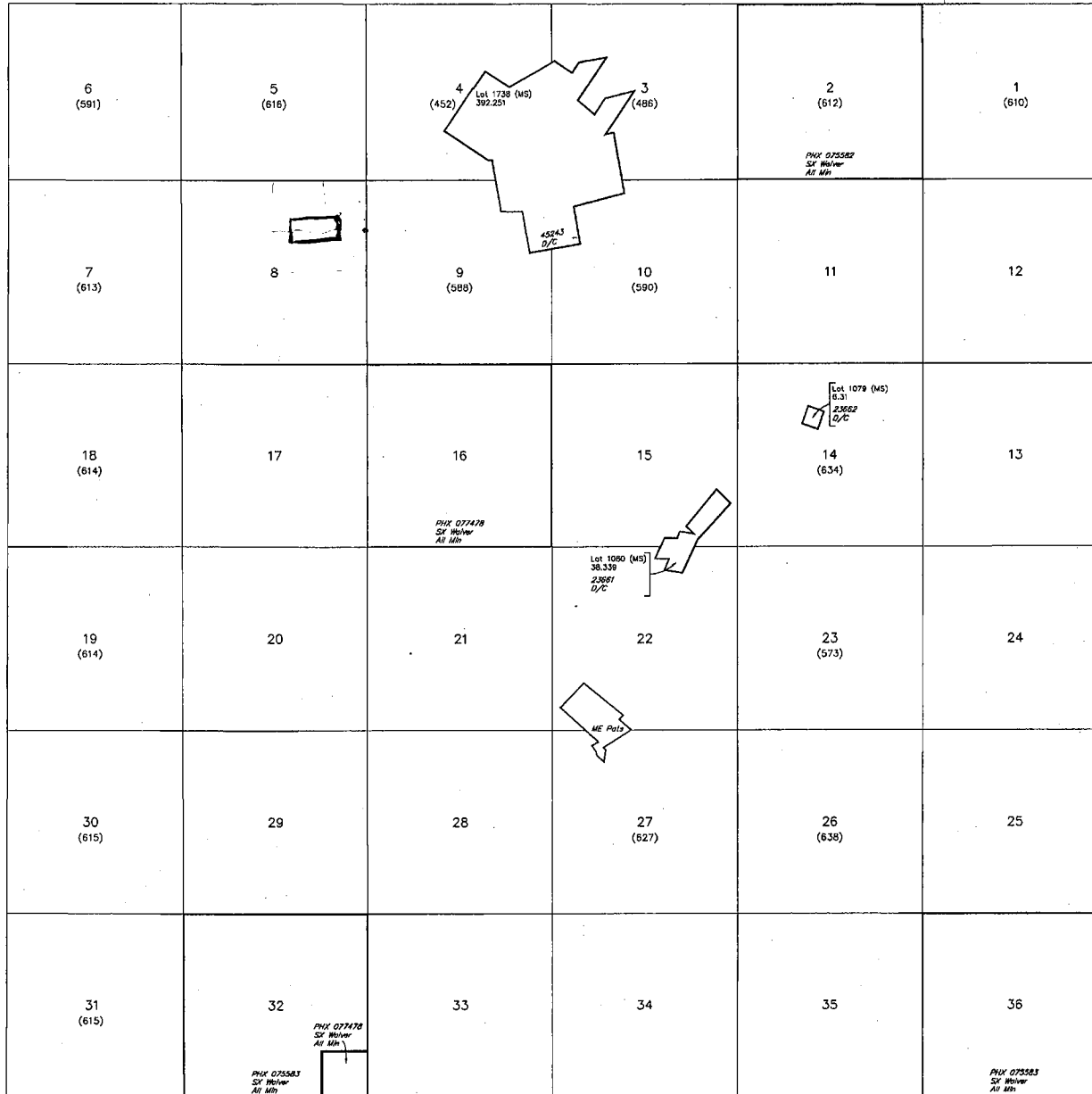

INDEX TO SEGREGATED TRACTS				
RESURVEY TRACT NO	ORIGINAL SURVEY			
	T	R	SEC	SUBDIVISION

FOR ORDERS AFFECTING DISPOSAL OR USE OF UNIDENTIFIED LANDS WITHDRAWN FOR CLASSIFICATION, MINERALS, WATER AND/OR OTHER PUBLIC PURPOSES, REFER TO INDEX OF MISCELLANEOUS DOCUMENTS.

Grazing Dist No 2

MDS 364 NE
365 NW
366 SE

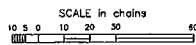

WARNING STATEMENT
This plot is the Bureau's record of title, and should be used only as a graphic display of the township survey data. Records herein do not reflect title changes which may have been affected by lateral movements of rivers or other bodies of water. Refer to the original surveys for official survey information.

CURRENT TO	NW	GSR Mer
9-5-2012	ACAD	T 4 N
		R 13 W

TOWNSHIP 10 NORTH RANGE 2 EAST OF THE GILA AND SALT RIVER MERIDIAN, ARIZONA

YAVAPAI COUNTY
HASSA YAMPA FIELD OFFICE

STATUS OF PUBLIC DOMAIN
LAND AND MINERAL TITLES
AND ACQUIRED LANDS

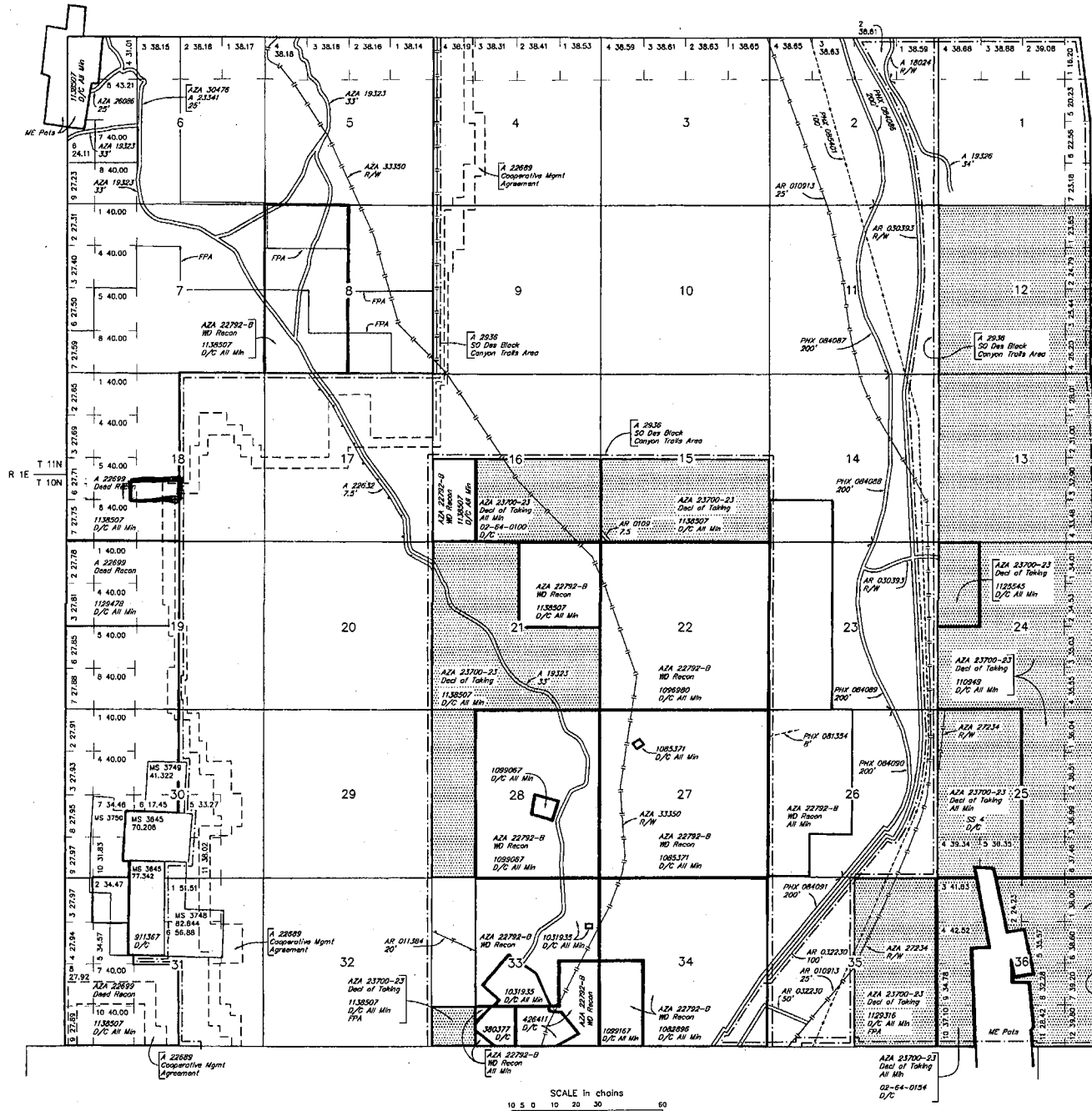

INDEX TO SEGREGATED TRACTS

RESURVEY TRACT NO	ORIGINAL SURVEY		SUBDIVISION
	T	R	

FOR ORDERS AFFECTING DISPOSAL OR USE OF UNIDENTIFIED LANDS WITHDRAWN FOR CLASSIFICATION, MINERALS, WATER AND/OR OTHER PUBLIC PURPOSES, REFER TO INDEX OF MISCELLANEOUS DOCUMENTS.

- MDS 40 NW
- 41 NW
- 43 SE
- 42 SW
- A 9270 PL 359 Secs 6 & 7
- A 22632 R/W 7.5'
- Sec 5: Lots I, A, SE1/4NW1/4, E1/2SW1/4 M&B
- ANC 314184, 314185 & 314187 PL 359 Sec 6
- ANC 314637 - ANC 314640 PL 359 Secs 7, 18
- AZA 22735 R/W
- Sec 24: W1/2W1/2NW1/4NW1/4
- AZA 22724 R/W
- Sec 33: SW1/4SW1/4
- AZA 27241 R/W
- Sec 16: SE1/4
- AZA 27212 R/W
- Sec 35: NW1/4NW1/4NE1/4
- AZA 27211 R/W
- Sec 35: NW1/4NE1/4
- AZA 23641 R/W
- Sec 5: W1/2
- Sec 17: SW1/4NE1/4, E1/2NW1/4, SE1/4
- Sec 20: NE1/4NE1/4

Lat 34°11'50"N
Long 112°05'20"W

CURRENT TO	GS
12-12-2008	PV

T 10 N
R 2 E

WARNING STATEMENT
This plat is the Bureau's Record of Title, and should be used only as a graphic display of the lawful survey data. Records herein do not reflect title changes which may have been effected by island movements of users or other bodies of water. Refer to the cadastral surveys for official survey information.

TOWNSHIP 23 NORTH RANGE 18 WEST OF THE GILA AND SALT RIVER MERIDIAN, ARIZONA

MOHAVE COUNTY
HONOHAN FIELD OFFICE

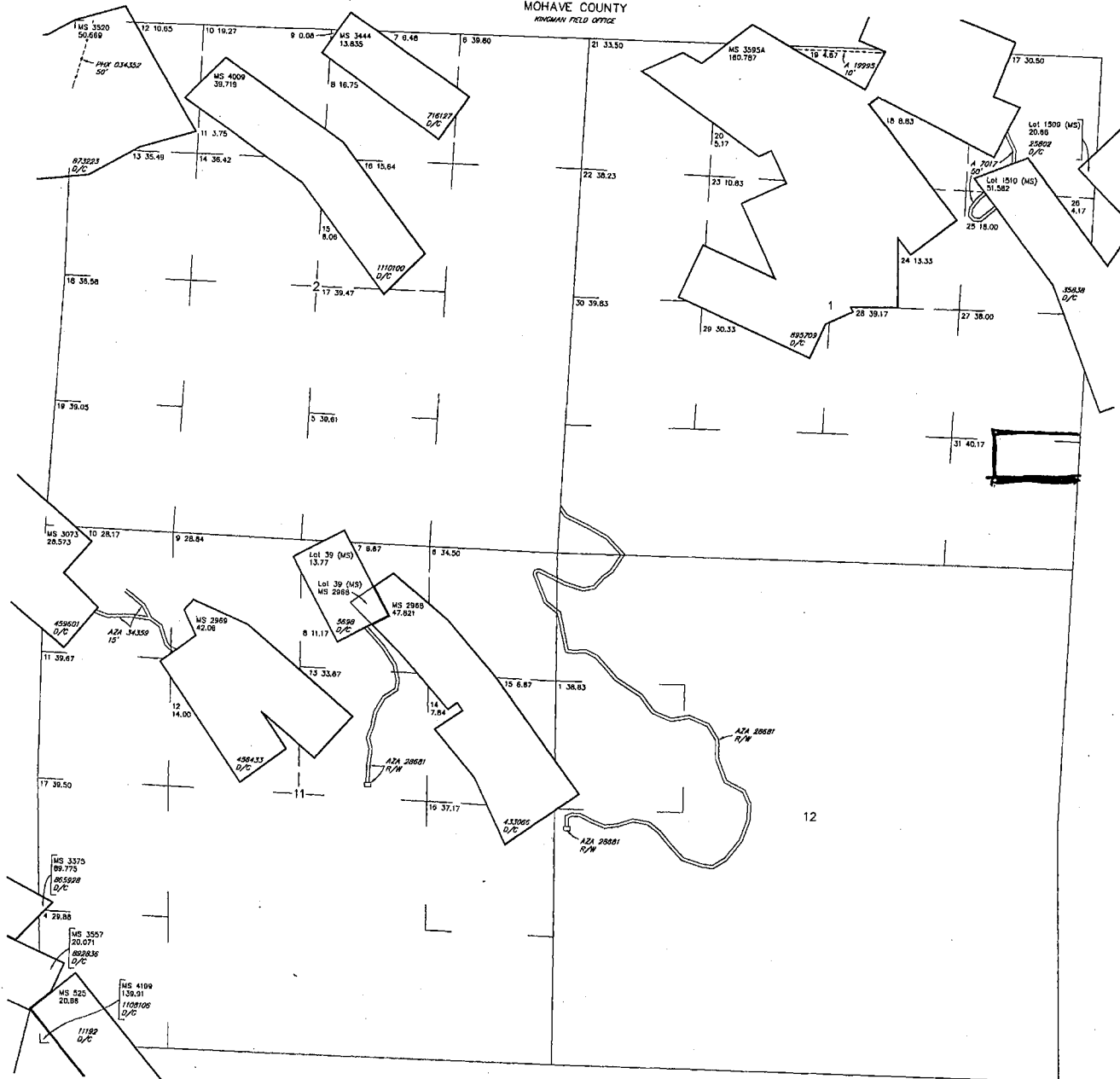

STATUS OF PUBLIC DOMAIN
LAND AND MINERAL TITLES

**MTP
SUPPL SECS 1,2,11,12**

INDEX TO SEGREGATED TRACTS				
RESURVEY	ORIGINAL SURVEY			
TRACT NO	T	R	SEC	SUBDIVISION

FOR ORDERS AFFECTING DISPOSAL OR USE OF UNIDENTIFIED LANDS WITHDRAWN FOR CLASSIFICATION, MINERALS, WATER AND/OR OTHER PUBLIC PURPOSES, REFER TO INDEX OF MISCELLANEOUS DOCUMENTS.

Grazing Dist No 2

MDS 451 NE

AZA 31001 R/W Precipitation Gauge
Sec 12: SW/NE1/4NW1/4

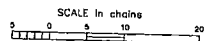

WARNING STATEMENT
This plat is the Bureau's record of title, and should be used only as a graphic display of the land survey data. Records hereon do not reflect title changes which may have been effected by formal instruments of title or other bodies of water. Refer to the cadastral maps for official survey information.

CURRENT TO	NW	GSR Mer
5-5-2015	ACAD	T 23 N
		R 18 W

NO 1

TOWNSHIP 23 NORTH RANGE 17 WEST OF THE GILA AND SALT RIVER MERIDIAN, ARIZONA

MOHAVE COUNTY
KRISHNAN FIELD OFFICE

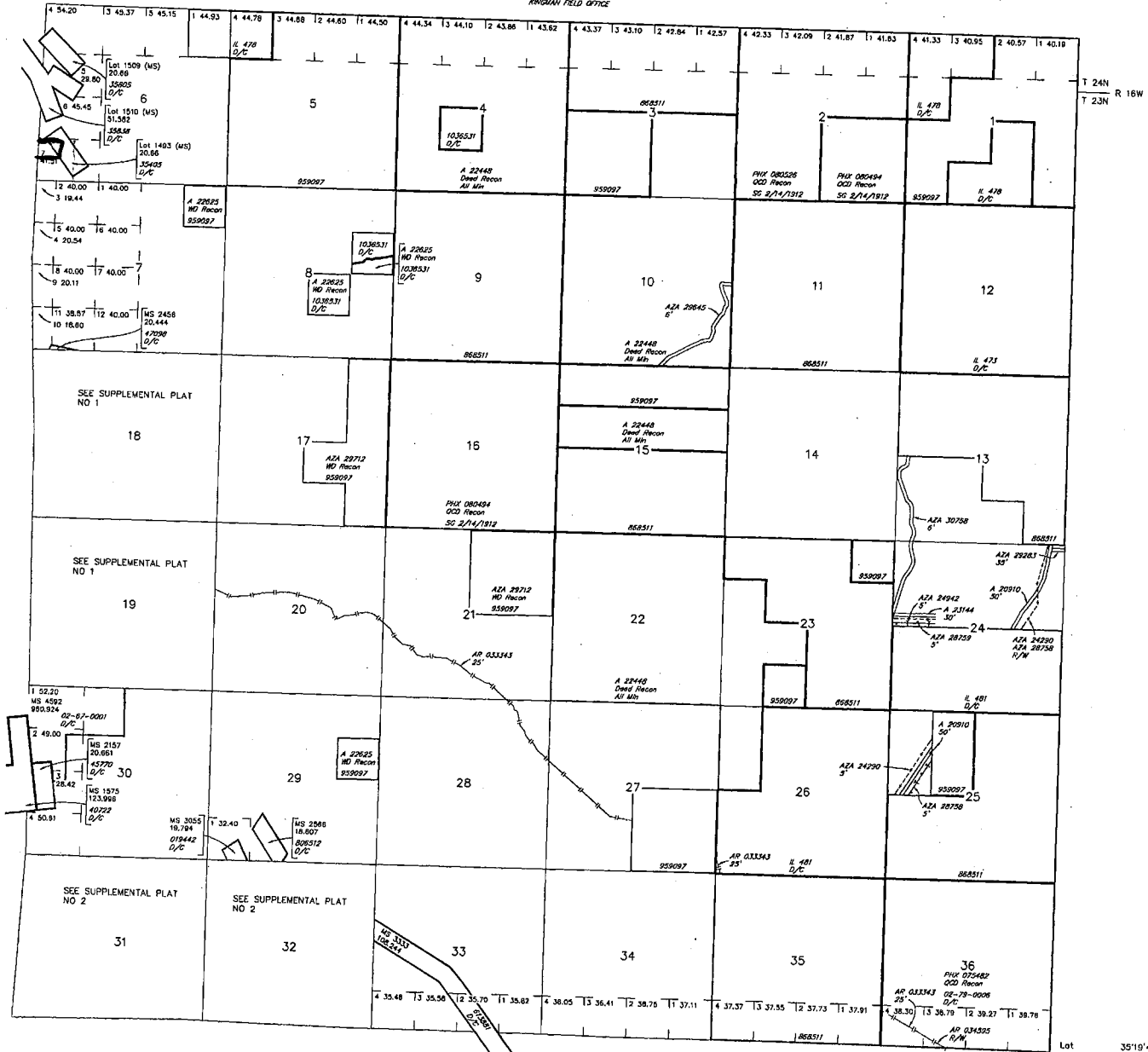

STATUS OF PUBLIC DOMAIN
LAND AND MINERAL TITLES

RESURVEY		ORIGINAL SURVEY			
TRACT NO	T	R	SEC	SUBDIVISION	

FOR ORDERS AFFECTING DISPOSAL OR USE OF
UNDEVELOPED LANDS WITHDRAWN FOR CLASSIFICATION,
MINERALS, WATER AND/OR OTHER PUBLIC PURPOSES,
REFER TO INDEX OF MISCELLANEOUS DOCUMENTS.

Grazing Dist No 2
MDS 435 NW
436 SW

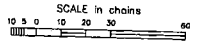

WARNING STATEMENT
This plot is the Bureau's Report of Title, and should be used only as a graphic display of the township survey data. Recorders herein do not reflect title changes which may have been affected by lateral movements of rivers or other bodies of water. Refer to the cadastral surveys for official survey information.

Lot	35°19'45"N	GSR Mer
Long	114°02'33"W	
CURRENT TO	NW	T 23 N
5-5-2015	ACAD	
		R 17 W

T. 23N, R. 12W.

SECTION 18



PAT. RURAL NO 2 2456
 BUCKEYE 1185
 WIRE SILVER 3687

PAT. LONE STAR 241
 GOLDEN STAR 2834

PAT. GOLDEN TREASURE 4142
 FRACTION 4142
 GABRIEL 4142

PAT. EAST KEYSTONE 4020
 JUNIPER 4592
 RED 4592
 RED 4592
 RED 4592
 RED 4592
 RED 4592
 RED 4592
 RED 4592

Dej
Information Inc.
942 Calle Amanecer Suite A
San Clemente, CA 92673

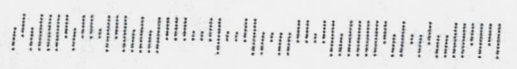

RECEIVED
BLM AZ STATE OFFICE
2015 OCT 13 P 3:13
PHOENIX ARIZONA



Bureau of Land Management
Arizona State Office
One Central Avenue
Suite 800
Phoenix, AZ 85004-4427